

DIGITUS[®] 254 mm (10") Network Components

Die 254 mm (10")-Network Components are ideal for SoHo applications like office areas. The wall mounting system offers space savings with only 6 height units. With suitable accessories you can build up your housing individually.

<p>6U Wall Mounting Cabinet DN-10-05U-1</p> 	<p>CAT 6 Patch Panel, shielded DN-91608S DN-91612S</p> 
	<p>CAT 5e Patch Panel, shielded / unshielded DN-91508S DN-91512S DN-91508U DN-91512U</p> 
	<p>Shelf, 1U DN-10 TRAY-1</p> 
	<p>Management Panel, 1U DN-10 ORG-1U</p> 
<p>PDU, 3x outlet DN-95411</p> 	

254 mm (10") Wall Mounting Cabinet



✓ 1.0 - 1.5 mm strong steel sheet

✓ Compact housing

✓ lockable front door

✓ Load capacity: 30 kg

Abstract

254 mm (10") Wall Mounting Cabinet, 6U, 312 mm width - 300 mm depth

Features

- 254 mm (10") profile rails mounted in the front, variable in depth
- Single pane safety glass door
- Housing complete grounded
- Dimensions (HxWxD): 330x312x300 mm
- Color: Grey (RAL 7035)

Technical Drawing

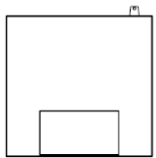

BOTTOM VIEW

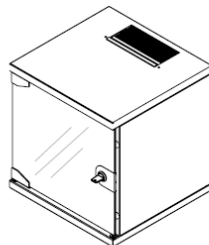

ISOMETRIC VIEW

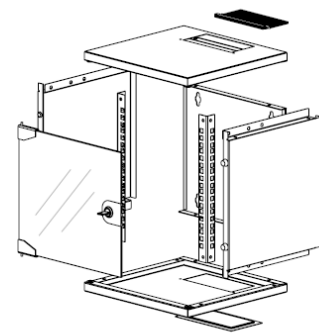

EXPLODED VIEW

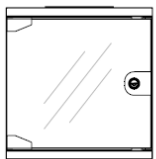

FRONT VIEW

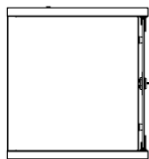

SIDE VIEW

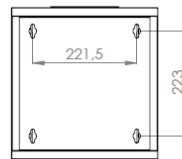

REAR VIEW

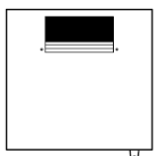

TOP VIEW

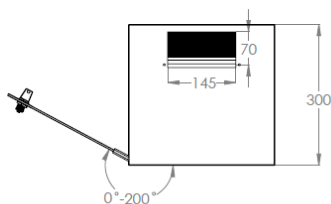

FRONT DOOR
OPENING ANGLE

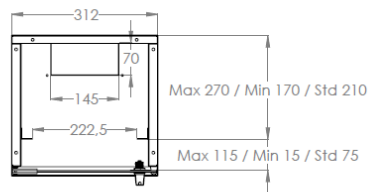

MAX/STD/MIN
EQUIPMENT
MOUNTING DISTANCE

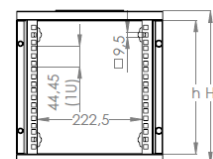

DIMENSIONS IN
WIDTH AND HEIGHT

254 mm (10") Patch Panel (LSA+) CAT 6 // CAT 5e



DN-91608S



DN-91508U

✓ 8- or 12-port

✓ CAT 6 shielded

✓ CAT 5e shielded/unshielded

✓ Color black (RAL 9005)

Abstract

254 mm (10") patch panel (LSA+) CAT 6 shielded, CAT 5e shielded, unshielded, 8- or 12-port

Features

- RJ45 sockets
- Cable installation via LSA strips, color coded acc. to EIA/TIA 568 A&B
- Norms: ISO/IEC 11801 2nd Ed; EN 50173-1; EIA/TIA 568-C
- Application areas: Up to 250 MHz; 1GBase-T (CAT 6); Up to 100 MHz; 10/100Base-T; 1GBase-T (CAT 5e)

Product Number Information

DN-91608S	Patch Panel CAT 6, 1U, 8-port, shielded
DN-91612S	Patch Panel CAT 6, 1U, 12-port, shielded
DN-91508S	Patch Panel CAT 5e, 1U, 8-port, shielded
DN-91512S	Patch Panel CAT 5e, 1U, 12-port, shielded
DN-91508U	Patch Panel CAT 5e, 1U, 8-port, unshielded
DN-91512U	Patch Panel CAT 5e, 1U, 12-port, unshielded

254 mm (10") Shelf

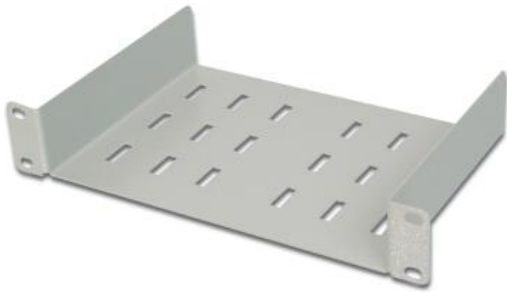

✓ Sturdy, perforated steel sheet

✓ Height unit: 1U

✓ Color: Grey (RAL 7035)

✓ Quick and easy mounting

Abstract

254 mm (10") shelf, fixed mounting, color grey (RAL 7035)

Features

- Sturdy, perforated steel sheet
- Complete with fixing material
- Mounting on the front 254 mm (10") profile rails

254 mm (10") Cable Management Panel



✓ Steel sheet

✓ Height unit: 1U

✓ Color: Grey (RAL 7035)

✓ Quick and easy mounting

Abstract

254 mm (10") cable management panel, 3 cable rings

Features

- Steel sheet
- 3 cable rings
- Mounting on the front 254 mm (10") profile rails

DIGITUS[®] 254 mm (10") Power Distribution Unit



✓ For 254 mm (10") rack mount

✓ 3x safety outlets

✓ Outlets turned by 35°

✓ Horizontal or vertical mounting

Abstract

DIGITUS[®] 254 mm (10") PDU with aluminum profile, 3x safety outlets

Features

- Suitable for 254 mm (10") rack mount
- 3 outlets, 250VAC, 50/60 Hz/16 A/4000 W
- Safety outlets turned by 35°
- Inclusive 2 metal brackets for 254 mm (10") rack mount
- 2 m power cable H05W-F3G 1,5 mm² with safety plug
- Right-angled safety plug with double earthing

Product Overview

The DIGITUS[®] power distribution units are the perfect solution for you 10" network- or server cabinet. Optimized for rack installation with 220-240V 50-60 Hz the DIGITUS[®] PDU offer you the best performance with qualified efficiency. The 10" fixing material provides an optimized enclosing on the profile rails of your cabinets. Every PDU can be mounted horizontally as well as vertically and has the possibility, according to the cabinet, to be mounted faced up or down.

Product Images

