

Portable Series

Tripod charming model



Specifications

Format	4:3		1:1	
Model	PT-H100	PT-H60	PT-H70	PT-H84
Specification(in)	100	60x60	70x70	84x84
Viewing Area WxH	mm	2030x1520	1520x1520	1720x1720
	in	79-15/16x59-27/32	59-27/32x59-27/32	67-23/32x67-23/32
L total length	mm	2192	1665	1863
	in	86-19/64	65-9/16	73-11/32
A size	mm	2225	1705	1896
	in	87-19/32	67-1/8	74-21/32
B1 size	mm	40	30	40
	in	1-9/16	1-3/16	1-3/16
Packaging LxWxH	mm	2370x175x110	1843x175x110	2041x175x110
	in	93-5/16x6-7/8x4-11/32	72-9/16x6-7/8x4-11/32	80-5/16x6-7/8x4-11/32
Net Weight (kg)	8.7	6.8	7.8	9.2
Gross Weight (Kg)	10.9	8.6	9.7	11.4
Optional Screen Fabrics				
WM8	✓	✓	✓	✓
WM7	✓	✓	✓	✓
GB8	✓	✓	✓	✓

Sizes and specifications are subject to change at anytime. [The tolerance for L is about ±5mm(3/16in)]

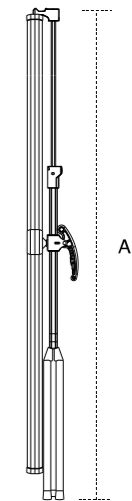
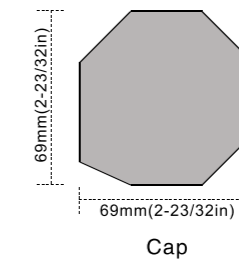
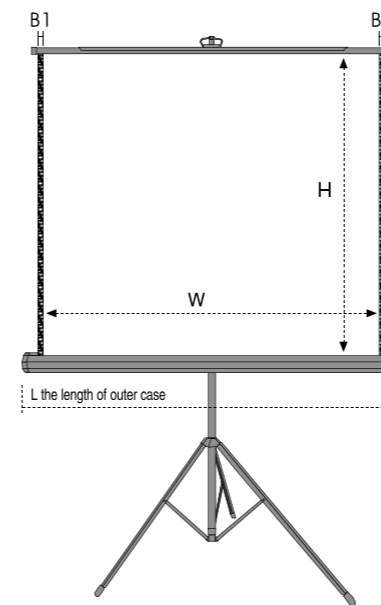

Part View

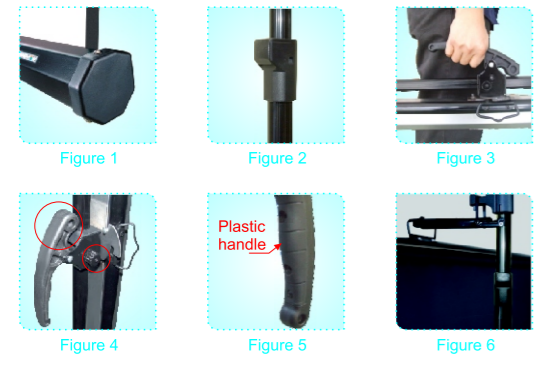

Product features >>>

- Trendy and Elegant** (Figure 1)
 The stylish black metal casing has a special coating on top to resist static electricity.
- Adjustable Stand** (Figure 2)
 The adjustable stand allows various heights suitable for every audience's need.
- Lightweight** (Figure 3)
 The design is compact and lightweight, ideal for a portable unit. Even though the screen is 80 inches, it only weighs about 6 kg.
- Special Design** (Figure 4,5)
 The user-friendly plastic handle can be used for many purposes such as portability and for height adjustment.
- Keystone Feature** (Figure 6)
 The compact and unique tripod design meets international standards. The special keystone adjustment enables all views from various angles.

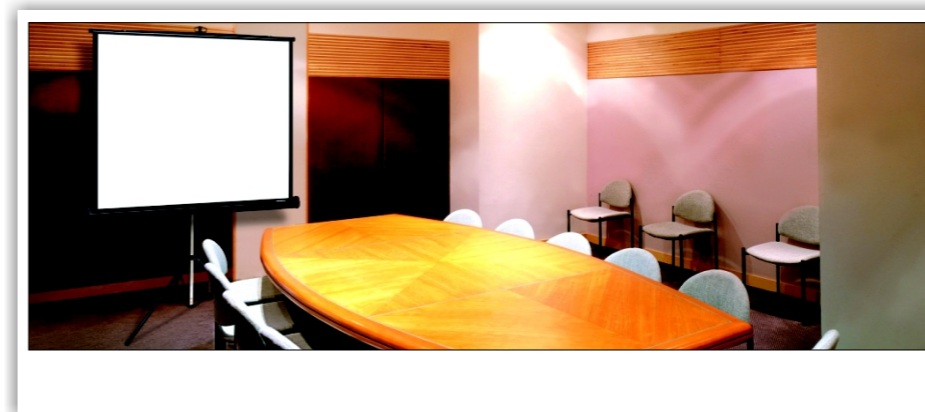

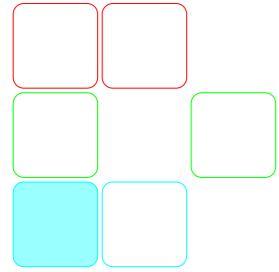

Portable Series

Tripod classic model



Part View



Product features >>

- Keystone features** (Figure 1)
 The compact and unique tripod design meets international standards. The special keystone adjustment enables views from various angles.
- Safe and Stability** (Figure 2)
 Thicker aluminum alloy tripod gives extra stability. The adjustable stand locks for safe use.
- Special Design** (Figure 3,4)
 The user-friendly plastic handle can be used for many purposes such as portability and for height adjustment. This brand new designed handle is easy to use. The uniquely shaped handle and locking system enables the stand to be fixed at the proper height.
- Durable and Convenient** (Figure 5)
 Utilizes modern features such as a innovative new handle design and easy to carry.
- Locking System** (Figure 6)
 Simple and practical adjustable screen lock is easy to use.
- Level adjustment device** (Figure 7)
 the device is used to maintain the screen at a horizontal level.

Specifications

Format	4:3		1:1	
Model	PT-L100	PT-L120	PT-L84	PT-L96
Specification(in)	100	120	84	96
Viewing Area WxH	mm 2030x1524	2334x1765	2030x2030	2334x2334
	in 79-15/16x60	91-7/8x69-1/2	79-15/16x79-15/16	91-7/8x91-7/8
L total length	mm 2214	2518	2214	2518
	in 87-1/8	99-7/32	87	99-7/32
A size	mm 2330	2610	2330	2610
	in 91-3/4	102-7/8	91-47/64	102-7/8
B1 size	mm 50	50	50	50
Net Weight (kg)	in 1-31/32	1-31/32	1-31/32	1-31/32
Distance H2	mm H ₂ >800	H ₂ >800	H ₂ >800	H ₂ >800
Packaging LxWxH	mm 2400x208x157	2704x215x155	2400x208x157	2704x208x157
	in 94-1/2x8-15/32x6-3/32	106-15/32x8-15/32x6-3/32	94-31/64x8-3/16x6-3/16	106-15/32x8-15/32x6-3/32
Net Weight (kg)	15	16.70	15.70	16.90
Gross Weight (Kg)	17.6	19.4	18.10	19.60
Optional Screen Fabrics				
WM5	✓	✓	✓	✓
WM7	✓	✓	✓	✓
GB1	✓	✓	✓	✓

Sizes and specifications are subject to change at anytime. [The tolerance for L is about ±5mm(3/16in)]

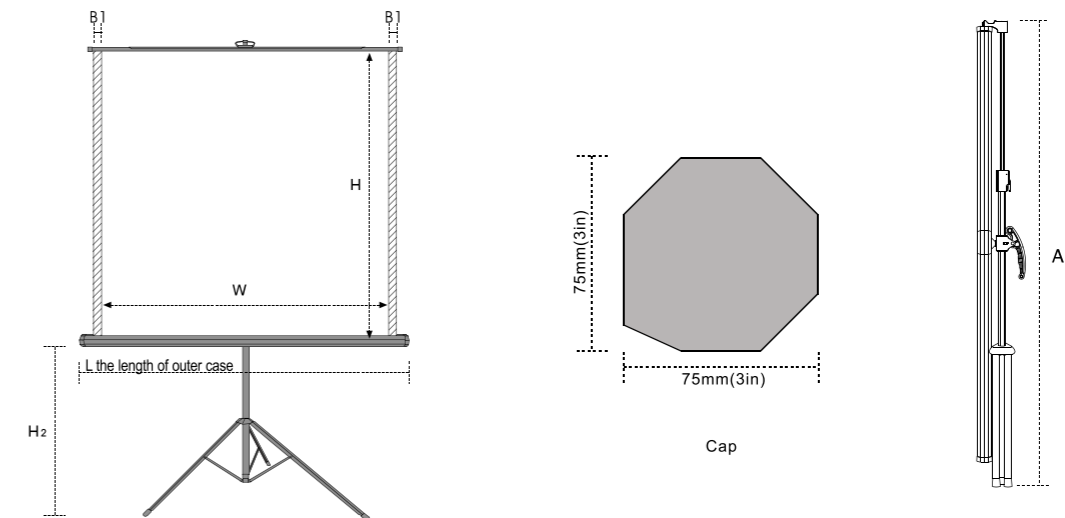

Promotion

Secure tripod classic model

The pressure stand is a brand new upgrade from the traditional stand. Although their appearances are exact the same, yet, this is a huge breakthrough for the new pressure stand in terms of its internal structure and components.

Built-in Security on-off on the lock button avoid the support bar out of place when touch the lock button incautiously during transport. Built-in air pressure mechanism secure the user while unlock the lock button incautiously during even if the screen fully pull up.



Security on-off

Portable Series

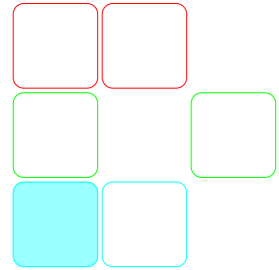

Table-top model
(For domestic sales only)



Part View

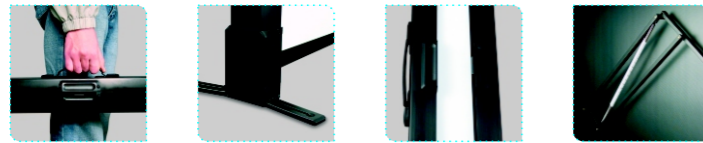

Figure 1

Figure 2

Figure 3

Figure 4

Product features >>

- **Simple and Trendy** (Figure 1)
The black aluminum alloy casing is stylish, light, and easy to carry.
- **Excellent Design** (Figure 2-3)
When a venue does not allow wall or ceiling mounted screens, this portable screen is your best option. Designed to work on tabletops, the aluminum alloy is light and strong. Simply extend the four legs and pull apart the casing by pressing the lock button.
- **Special Feature** (Figure 4)
A unique spring system expands and effectively secures the screen in place. Both sides of the casing lock when the screen is in use.
- **Location**
It is suited for mobile venues such as office, boardroom.

Specifications

Format	4:3	
Model	PT-B40	PT-B50
Specification(in)	40	50
Viewing Area WxH	810X610	1020X760
	mm	
	in	
L total length	31-7/8x24	40-5/32x29-15/16
	mm	
	in	
A size	715	865
	mm	
	in	
B3 size	28-5/32	34-1/16
	mm	
	in	
B2 size	25	25
	mm	
	in	
Packaging LxWxH	805x125x130	955x125x130
	mm	
	in	
	31-11/16x4-15/16x5-1/8	37-19/32x4-15/16x5-1/8
Net Weight (kg)	2.5	3
Gross Weight (Kg)	2.7	3.3
Optional Screen Fabric		
WM8	✓	✓

Sizes and specifications are subject to change at anytime. [The tolerance for L is about ±5mm(3/16in)]

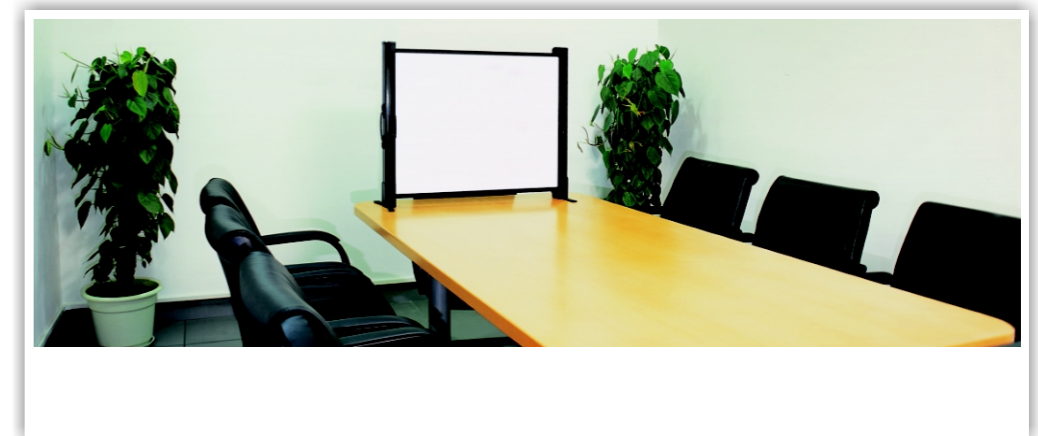
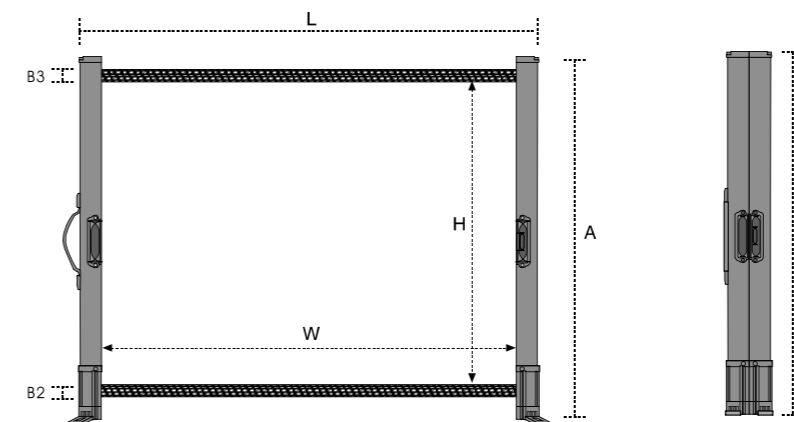

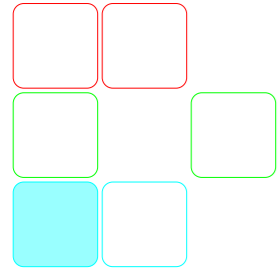

Portable Series

Portable pull-up



Specifications

Format	4:3					16:9					
	Model	CB-U40	CB-U50	CB-U60	CB-U70	CB-U80	CB-U40	CB-U50	CB-U60	CB-U70	CB-U80
Specification(in)	40	50	60	70	80	40	50	60	70	80	
Viewing Area WxH	mm	813x610	1016x762	1220x914	1422x1067	1625x1220	885x498	1107x622	1328x747	1550x871	1770x995
	in	32x24	40x30	48-1/32x36	56x41-31/32	63-31/32x48-1/32	34-27/32x19-19/32	43-19/32x24-1/2	52-9/32x29-3/8	61-1/32x34-9/32	69-11/16x39-3/16
L total length	mm	963	1166	1380	1582	1785	1035	1257	1488	1710	1916
	in	37-29/32	45-29/32	54-11/32	62-9/32	70-9/32	40-3/4	49-1/2	58-19/32	67-5/16	75-7/16
A size	mm	953	1258	1588	1860	2168	1042	1372	1714	1951	2281
	in	37-17/32	49-1/2	62-1/2	73-7/32	85-11/32	41	54	67-1/2	76-13/16	89-13/16
B1 size	mm	30	30	35	35	35	30	30	35	35	28
	in	1-3/16	1-3/16	1-3/8	1-3/8	1-3/8	1-3/16	1-3/16	1-3/8	1-3/8	1-1/8
B2 size	mm	25	25	25	25	25	25	25	25	25	25
	in	1	1	1	1	1	1	1	1	1	1
B3 size	mm	140	290	460	560	710	340	540	760	870	1050
	in	5-1/2	11-13/32	18-1/8	22	27-31/32	13-3/8	21-1/4	29-15/16	34-1/4	41-11/32
Packaging LxWxH	mm	1063 x182x149	1266 x182x149	1480 x182x149	1682 x182x149	1885 x182x149	1135 x182x149	1357 x182x149	1588 x182x149	1810 x182x149	2030 x182x149
	in	41-27/32 x7-5/32x5-7/8	49-27/32 x7-5/32x5-7/8	58-9/32 x7-5/32x5-7/8	66-7/32 x7-5/32x5-7/8	74-7/32 x7-5/32x5-7/8	44-11/16 x7-5/32x5-7/8	53-7/16 x7-5/32x5-7/8	62-17/32 x7-5/32x5-7/8	71-1/4 x7-5/32x5-7/8	79-29/32 x7-5/32x5-7/8
Net Weight (kg)		3.3	3.9	4.6	5.2	6.0	3.4	4.1	4.7	5.4	6.1
Gross Weight (Kg)		4.5	5.3	6.1	7.0	7.9	4.7	5.5	6.4	7.3	8.2
Optional Screen Fabric											
WM4		✓	✓	✓	✓	✓	✓	✓	✓	✓	✓

Sizes and specifications are subject to change at anytime. [The tolerance for L is about ±5mm(3/16in)]

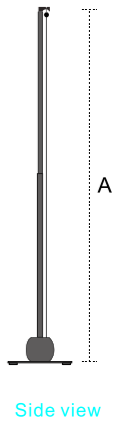
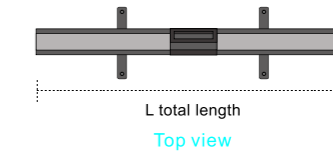
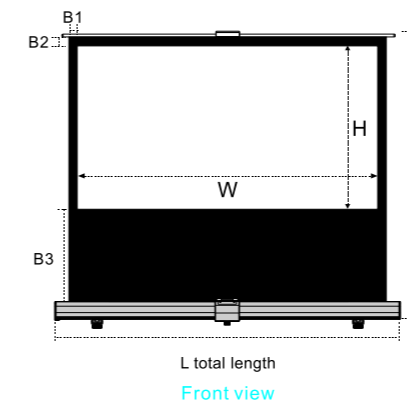

Part View

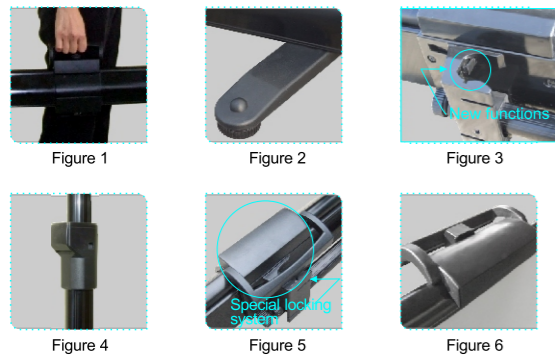

Product features >>>

- Light and Portable (Figure 1)**
 The design is compact and lightweight, ideal for a portable unit. For a 80" screen, it weighs only 6kg.
- Attention to Detail (Figure 2)**
 The two stands have height-adjusting wheels, they can be adjusted to keep screen stably, while concealed under the casing after using.
- Special Locking Design (Figure 3)**
 The locking system will be automatically unlocked when raising the uphold bar, then we can pull up the screen.
- Easy and Convenient (Figure 4)**
 The patented bar locking system assure bar to raise up smoothly without pressing the button.
- Uniquely Designed Handle (Figure 5)**
 After hang the handle basing onto the top hook, we can lock the handle back to secure screen stably.

Instruction



Portable Series

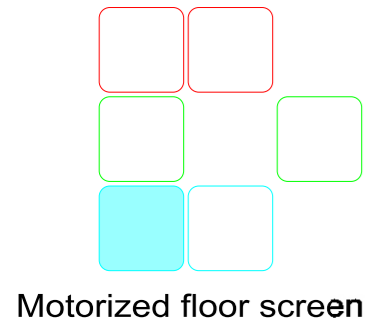

Motorized floor screen



Specifications

Format	4:3		16:9	
Model	CB-UM80	CB-UM100	CB-UM70	CB-UM80
Specification(in)	70	80	70	80
Viewing Area WxH	mm 1422X1066	1625X1220	1550X871	1770X995
	in 56x41-31/32	63-31/32x48-1/32	61-1/32x34-9/32	69-11/16x39-3/16
L total length	mm 1697	1900	1800	1962
	in 66-13/16	74-13/16	68-19/32	77-1/4
A size	mm 1860	2100	1850	2010
	in 73-1/4	82-11/16	76	79-1/8
B1 size	mm 35	35	35	35
	in 1-3/8	1-3/8	1-3/8	1-3/8
B2 size	mm 25	25	20	30
	in 1	1	2-3/8	2-3/8
B3 size	mm 610	710	800	850
	in 24	27-31/32	35	33-15/32
Packaging LxWxH	mm 1682X333X199	2085X333X199	1895X333X199	2075X333X199
	in 66-1/4X13-1/8X7-27/32	110-7/16X13-1/8X7-27/32	74-19/32X13-1/8X7-27/32	81-11/16X13-1/8X7-27/32
Net Weight (kg)	17	19	18	20.4
Gross Weight (Kg)	19	21.5	20.5	23
Optional Screen Fabric				
WM5	✓	✓	✓	✓

Sizes and specifications are subject to change at anytime. [The tolerance for L is about ±5mm(3/16in)]

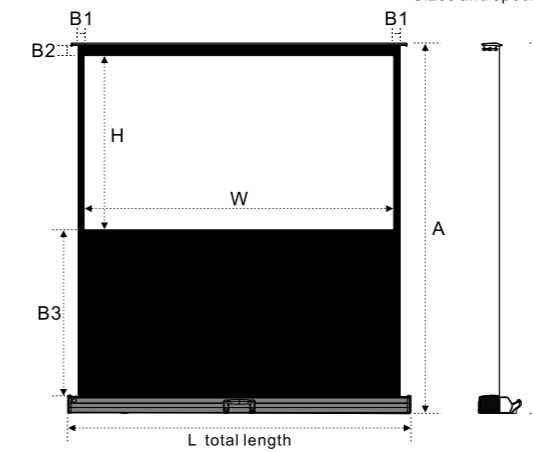

Power Specifications			
Voltage	Frequency	Watts	Application
220V/120V/100V	50Hz/60Hz	85W/85W	Applicable for all Cyber motorized portable screens

Product features >>

- Unique design of Motorized floor screen.
- Smooth operating motorized scissor assisted structure.
- Suited for various venues such as education facilities, home theatres, boardrooms, or other entertainment sites.
- Has three kind of control methods and several security mechanism; motorized spring-assisted scissor raise or retract the screen from or into the case and ensure smooth operation and screen surface flat.

Instructions

1. Lay the bases flat on the ground or on the working surface. (Figure 1)



Figure 1

2. Push the bottom on the lower left corner of the case to open the board, (Figure2-4) you will find the power cable and controller inside.



Figure 2

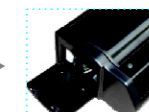

Figure 3



Figure 4

3. Plug-in the power cord. (within allowable voltage). (Figure5-6)

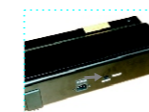

Figure 5

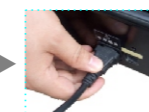

Figure 6

4. You could control the electric floor screen with options by built-in IR remote or external IR receiver or manual control button.

