

# Func Wall/Floor Motorized



---

## Stable & ergonomic

Func Wall/Floor Motorized is easy to adjust for different needs. The very stable design is perfect for large heavy displays and touch-sensitive displays. The motorized height adjustment ensures the user to present or interact with the display in an ergonomic position, whether very tall, short, standing up or sitting down. The design includes a storage box for e.g. mini PC, codec or laptop, easily accessed from the front. The box can be locked with a padlock (not supplied).

**INFO**

Finish: Black  
Rec. display size: From 46"  
Maximum display weight: 120 kg  
Horizontal VESA: 200 - 800  
Vertical VESA: 100 - 400  
Stroke: 500 mm  
Dedicated area for storage inside the product [mm]:  
496 x 472 x 96.  
Lockable: with the accompanying locking pin or with a pad-  
lock (not included).

**ART. NO.**  
**FMT091001**

**DESCRIPTION**  
Func Wall/Floor Motorized

**PRODUCT DIMENSIONS [mm]**

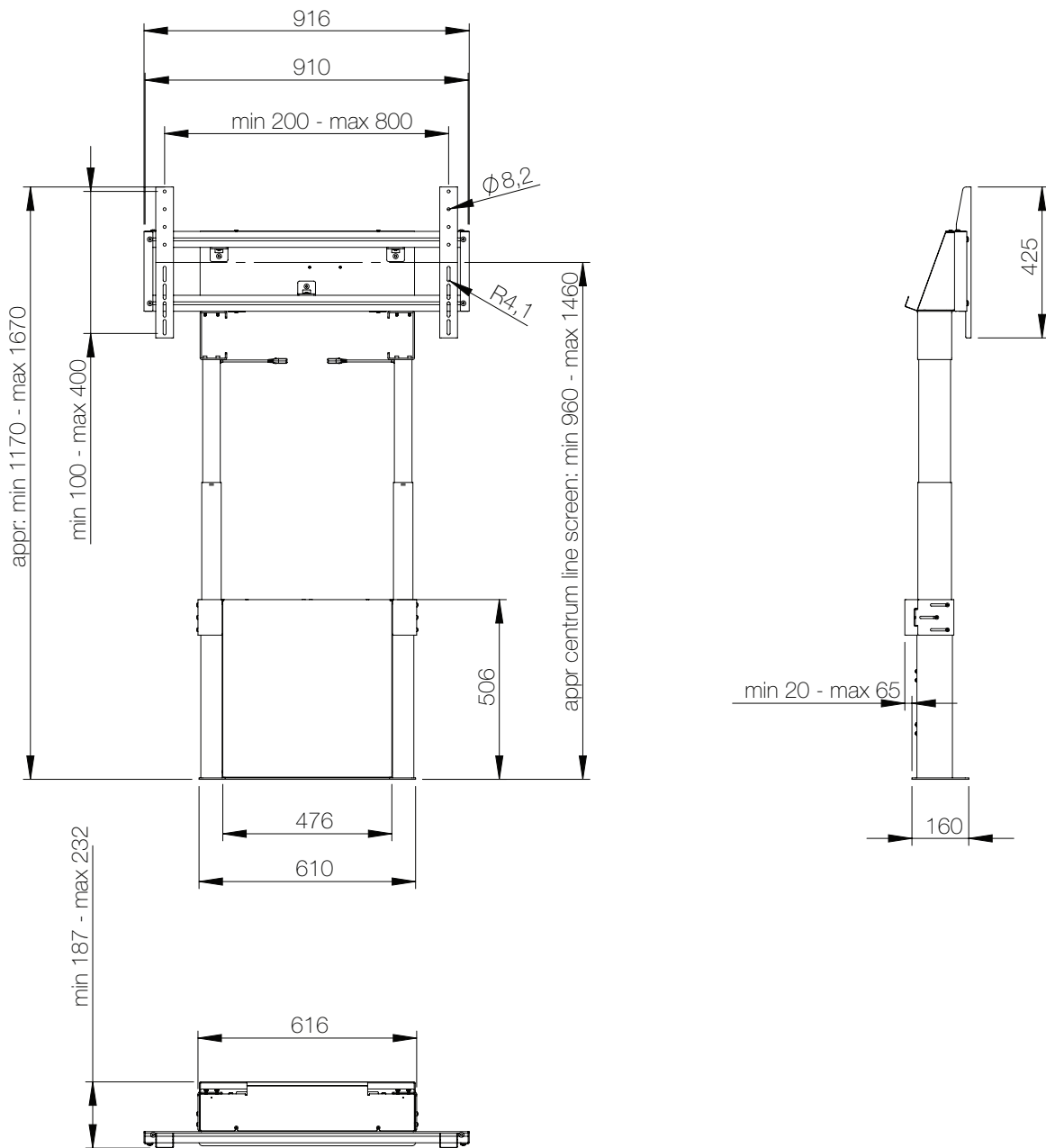

We reserve the right to introduce changes in the product specifications after the printing and publication of this document.