

# Argus 2E

Argus 2E runs on a non-removable high-capacity rechargeable battery. Without power cables, it provides clean, easy and flexible installation. You can put it anywhere you want, indoors or outdoors.

## 1. Specs



1	Daylight Sensor
2	6 IR LEDs
3	Lens
4	Status LED
5	Built-in PIR Motion Sensor
6	Built-in Mic
7	Outdoor Security Mount



1	Reset Button
2	Micro SD Card Slot
3	Micro USB Port
4	Speaker

## Status Light

Status Light	Camera Status
Red light	Wi-Fi connection failed
Blue light	Wi-Fi connection succeeded
Blinking	Standby status
On	Working status

## 2. Setup and Install

### Set up the Camera

#### What's in the Box

**Note:** The package content may vary and update with different version and platforms, please take the below information only for a reference. And the actual package content are subject to the latest information on the product selling page.  
Argus 2E



Argus 2E\*1



USB Cable\*1



Quick Start Guide\*1



Security Bracket\*1



Stand Bracket\*1



Mounting Template\*1



Surveillance Sticker\*1



Pack of Screws\*1



Reset Needle\*1



Strap\*1

## Set up the Camera on the App

Please follow the steps below to do initial setup for the battery-powered cameras via Reolink App.

**Step 1.** Power on the camera. Remember to turn on the power switch on the camera before initial setup except for Argus 2 and Argus Pro. After a startup sound, you will hear a **repeated Ding sound** or a **voice prompt**.

**Note:** The voice prompt you will hear may be "Welcome to Reolink, please install Reolink app and scan the QR code on the camera" in multilingual versions, or "please run Reolink app, add the camera and set it up".

**Step 2.** Tap the icon  in the top right corner to start the initial setup.

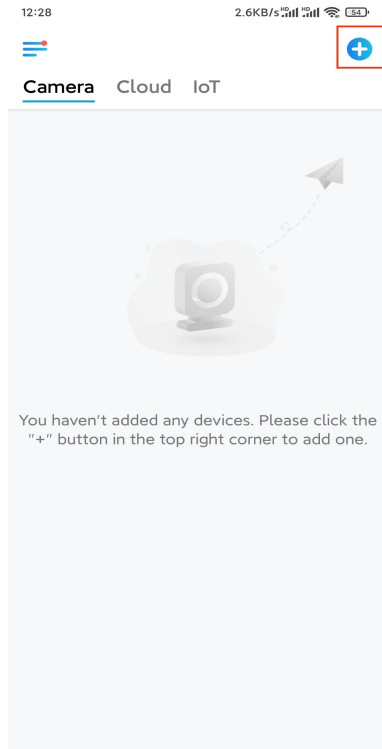

**Step 3.** Scan the QR code on the back of the camera. You may tap **Light** to enable a flashlight when setting up the camera in a dark environment. If the phone doesn't respond, please tap **Input UID/IP** and then manually type in the UID (16-digit characters under the QR code of the camera). Then click **Next**.

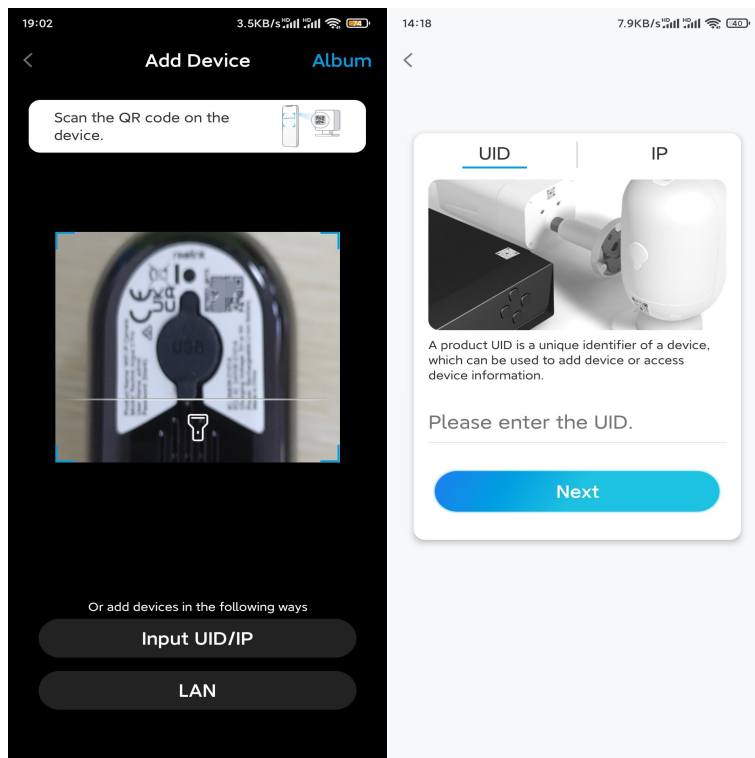

**Step 4.** Select **Wi-Fi Not Configured**. If you hear a voice prompt played by the camera, please tick correspondingly and then tap **Next**.

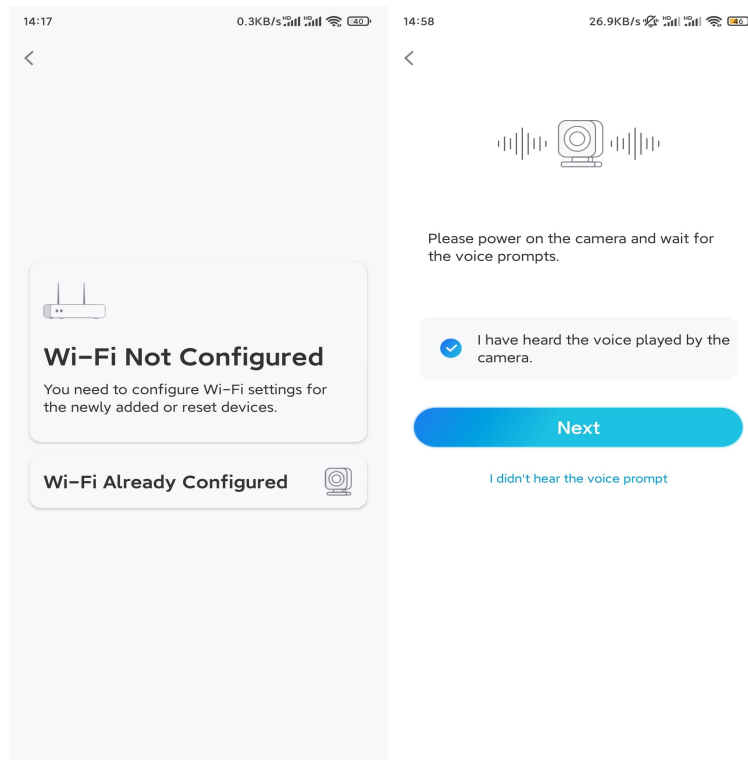

**Step 5.** Enter the WiFi password of the selected WiFi network (you may tap the right eye icon to see and double-check the password) and tap **Next**.

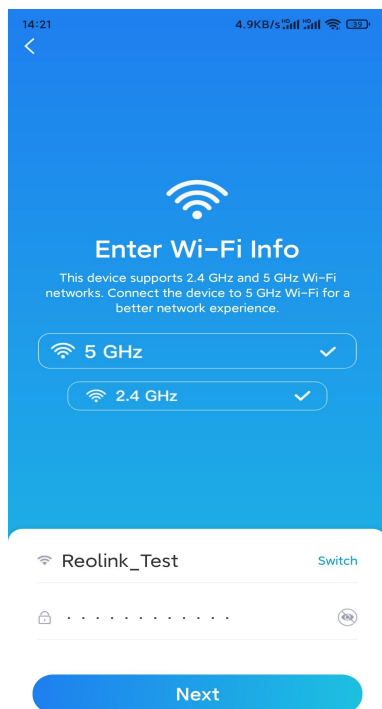

**Note:** Argus 2E only supports the WiFi frequency of 2.4GHz.

**Step 6.** Tap **Scan Now**. Place the QR code on your phone in front of the camera's lens at a distance of about 20 cm (8 inches) and let the camera scan the QR code. Tick correspondingly and tap **Next**.

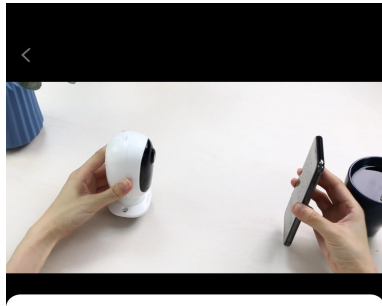

14:22 10.2KB/s



Please face the camera towards QR code and keep scan distance around 20 cm (8 inches).

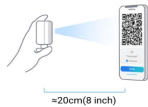

To connect your camera to Wi-Fi network, face it to your phone and let the camera scan the QR code on the screen.

I have heard a beep sound from the camera. [Demo](#)

**Next**

[Scan failed?](#)

**Scan Now**

**Step 7.** Wait around 60 seconds for the camera to connect to the router. After hearing "connection to the router succeeded", tick correspondingly and tap **Next**.

14:22 6.2KB/s

<



Camera is connecting to the router...



**Connection to the router succeeded**

I have heard the voice prompt

**Next**

[Connection to the router failed](#)

**Step 8.** Create a login password and then name your camera.

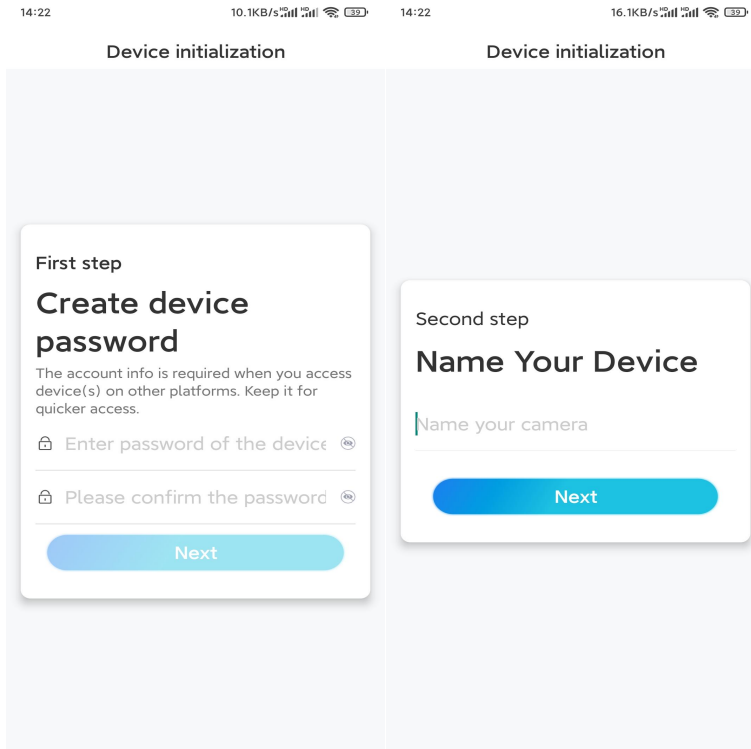

**Step 9.** Read the note below and then tap **Finish** to complete the initialization of your camera.

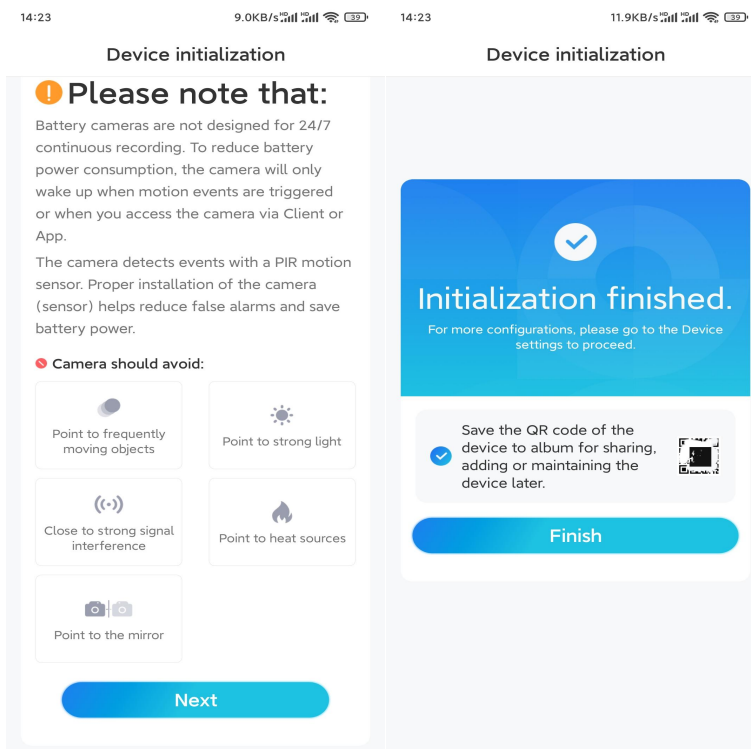

Once the initial setup is completed, you may choose a good position to mount your camera.

## Install the Camera

We offer you guides on three different scenes in which the camera could be installed. Check out them respectively.

### Mount the Camera to the Wall

**Step 1.** Rotate to separate the base from the security mount.



**Step 2.** Drill holes with the mounting template and screw the base of the mount onto the wall. Then attach the other part of the mount to the base.

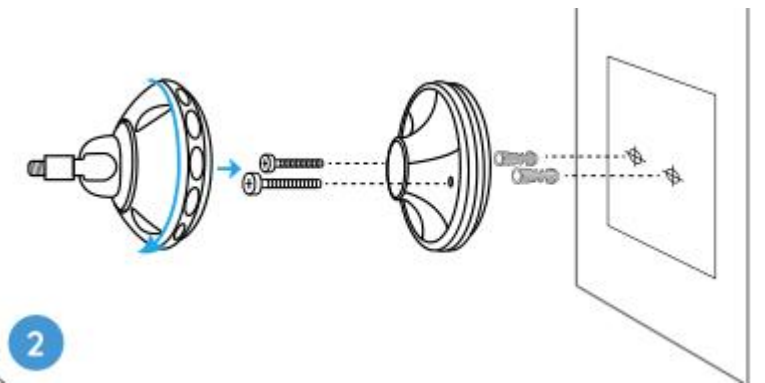

**Step 3.** Screw the camera to the mount.

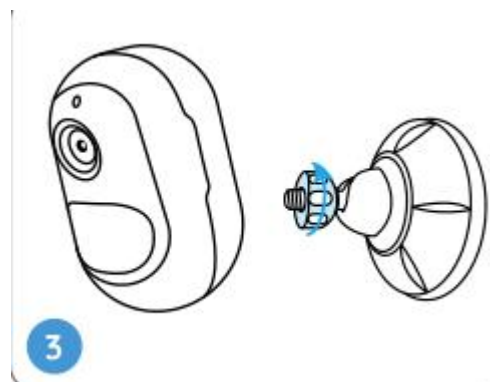

**Step 4.** Adjust the camera's angle to get the best field of view.





**Step 5.** Secure the camera by turning the part on the mount identified in the chart clockwise.

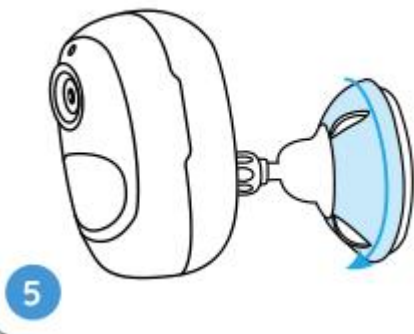

**Note:** To adjust the camera angle later, please loosen the mount by turning the upper part counterclockwise.

### Install the Camera with Loop Strap

If you'd like to install the camera to a tree stem, follow up on the mounting method below.

**Step 1.** Thread the loop strap through the slot at the bottom of the security bracket.

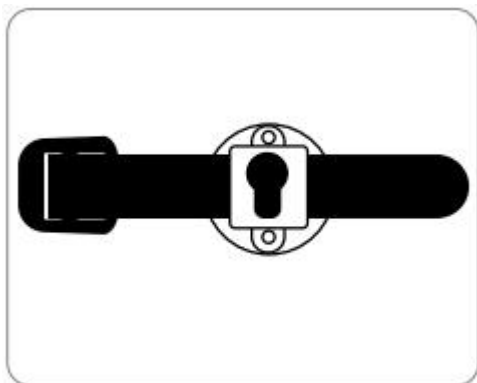

**Step 2.** Fasten the strap around the tree tightly.

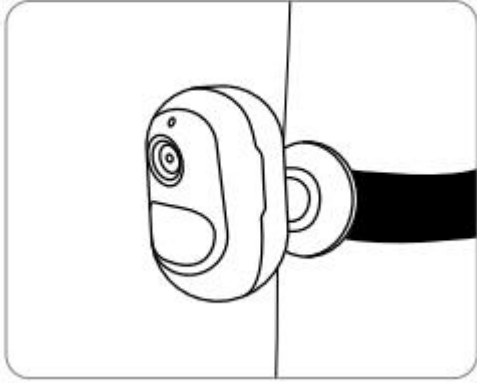

### Place the Camera on a Surface

If you plan to place the camera on a **level** surface indoors, for example, on the bookshelf, you could put the camera into the stand bracket and adjust the camera angle by slightly rotating the camera back and forth.

