

# Quick Start Guide

Outdoor Security  
Wi-Fi Camera

Images may differ from actual products.

7106509192 REV1.0.0

## Package Contents

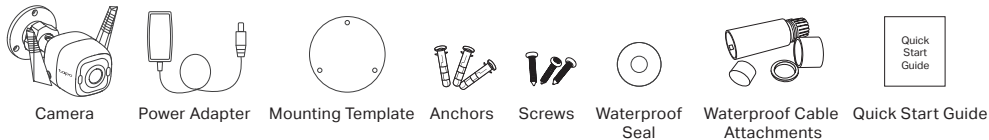

## Appearance

Front Panel

Bottom Panel

System LED Status

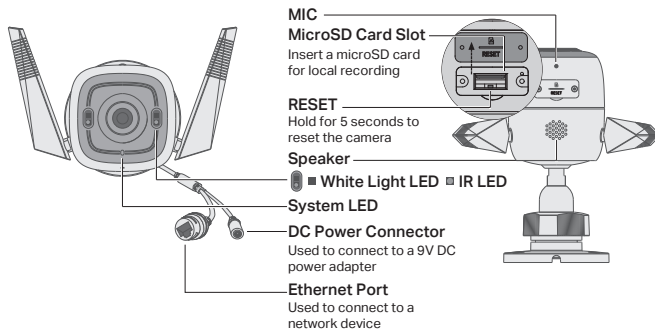

Solid red	Starting up
Blinking red and green	Ready for setup
Blinking red slowly	Connecting to Wi-Fi
Solid amber	Connected to Wi-Fi
Solid green	Connected to TP-Link Cloud server
Blinking red quickly	Camera resetting
Blinking green quickly	Camera updating

## Set Up Camera

### STEP 1

### DOWNLOAD APP

Get the **Tapo** app from the Apple App Store or Google Play.



Scan to download

### STEP 2

### POWER UP

Plug in your camera and wait until the LED blinks red and green.

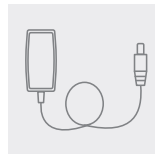

### STEP 3

### SET UP

Tap the ⊕ button in the app and select your model. Follow app instructions to complete setup.

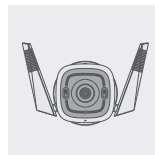

## Wall Mounting Instructions

### 1. Drill Holes

Stick the mounting template to the desired mounting place. Drill 3 screw holes according to the template.

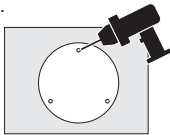

### 2. Mount Camera

Insert three anchors into the holes and use the screws to affix the camera over the anchors.

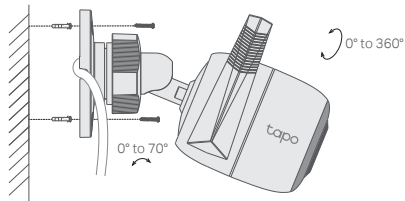

Note: After mounting the camera, remember to connect it to a power outlet using the provided power adapter.

## Install Waterproof Cable Attachments

Install the waterproof cable attachments for the network interface when the camera is installed outdoors.

Note: Make sure each part is securely attached and the water-proofing rings are flush to keep out water.

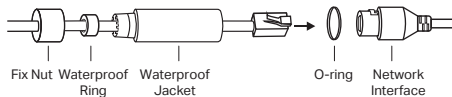

1. Route the network cable through the following components in order: fix nut, waterproof ring, and then the waterproof jacket.
2. Insert the waterproof ring into the waterproof jacket.
3. Fix the O-ring to the network interface of the camera and connect the network cables.
4. Attach the network interface with the waterproof jacket, then twist to lock. Rotate the fix nut to secure it to the waterproof jacket.

**Done!** The network interface is now waterproof.

## Install Waterproof Seal for Power Connectors

Install the waterproof seal for the power connectors when the camera is installed outdoors.

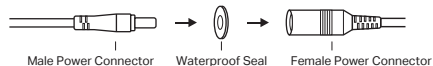

## FAQ (Frequently Asked Questions)

### Q1. What should I do if I fail to configure Tapo Camera?

- Visit <https://www.tp-link.com/support/faq/2747/> for detailed instructions.

### Q2. What should I do if the SD card is not working properly?

- Make sure you are using a microSD card.
- It's recommended to use a Class 10 microSD card or higher, with storage from 8 GB to 256 GB.
- Make sure you have initialized the microSD card in the Tapo app.
- If the problem still persists, contact our technical support.

### Q3. How do I reset the camera?

- With the camera powered on, press and hold the Reset button for about 5 seconds until the System LED blinks red quickly to reset the camera.
- Open the Tapo app, go to the Camera Settings page, and remove the camera to reset it.

For more questions, please refer to <https://www.tp-link.com/support/faq/2742/>



For technical support, the user guide, and more information, please visit [www.tapo.com/support/](http://www.tapo.com/support/)



- Do not use damaged charger or USB cable to charge the device.
  - Do not use any other chargers than those recommended.
  - Do not use the device where wireless devices are not allowed.
  - Adapter shall be easily accessible.
  - Use only power supplies which are provided by manufacturer and in the original packing of this product. If you have any questions, please don't hesitate to contact us.
  - Keep the device away from fire or hot environments. DO NOT immerse in water or any other liquid.
  - Do not disassemble, repair or modify the product.
  - Do not use the product if the casing has been broken. Danger of electric shock.
  - Never touch the product with wet hands.
  - Do not place near automatically controlled devices such as fire alarms. Radio waves emitted from this product may cause such devices to malfunction resulting in an accident.
  - Observe restrictions on using wireless products in fuel depots, chemical plants or when blasting operations are in progress.
  - Do not use liquid to clean the product. Only use a dry cloth.
  - Never put metal objects inside the product. If a metal object enters the product turn off the circuit breaker and contact an authorised electrician.
  - This product is not intended to be used when providing medical care. Consult the manufacturer of any personal medical devices, such as pacemakers or hearing aids to determine if they are adequately shielded from external RF (radio frequency) energy.
  - Do not use this product in health care facilities. Hospitals or health care facilities may be using equipment that could be sensitive to external RF energy.
  - Do not place heavy objects on top of the product.
  - When you leave the product unused for a long time unplug the product from the power outlet.
  - Product should be kept away from heat sources such as radiators, cookers etc. - it should not be placed in places where the temperature is less than -20 degrees or greater than 45 degrees.
  - This product may interfere with other electronic products such as TV, radios, personal computers, phones or other wireless devices.
- Operating Temperature: -20 °C ~ 45°C (-4°F ~ 113°F)  
Operating Humidity: 10%~90%RH, Non-condensing
- Please read and follow the above safety information when operating the device. We cannot guarantee that no accidents or damage will occur due to improper use of the device. Please use this product with care and operate at your own risk.
- TP-Link hereby declares that the device is in compliance with the essential requirements and other relevant provisions of directives 2014/53/EU, 2009/125/EC, 2011/65/EU and (EU)2015/863.
- The original EU declaration of conformity may be found at <https://www.tapo.com/support/ce>

