

Connection diagrams with Axessline outlet strips



Four required product types

Outlet strips

Title	Art. No
1 Axessline - 2 power, 2 USB-ch., 1 HDMI, 2 Data, 2 USB	935-T2UD
2 Axessline - 5 power, 2 USB-ch., 1 HDMI, 4 Data, 2 USB	935-T5UD
3 Axessline - 7 power, 2 Data, Wieland in/out (Male & Female)	935-T7DD

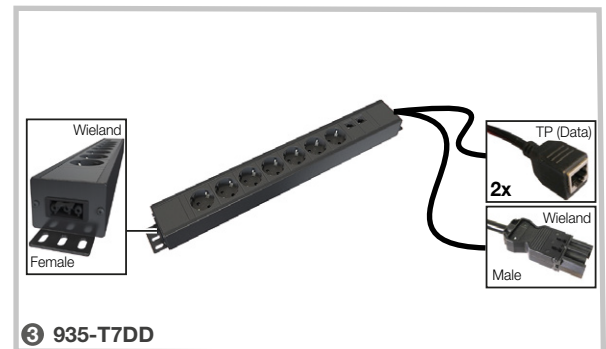
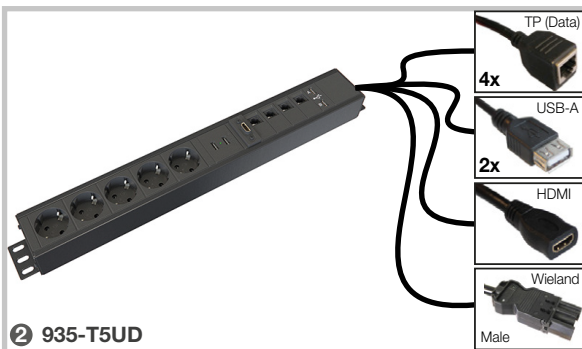
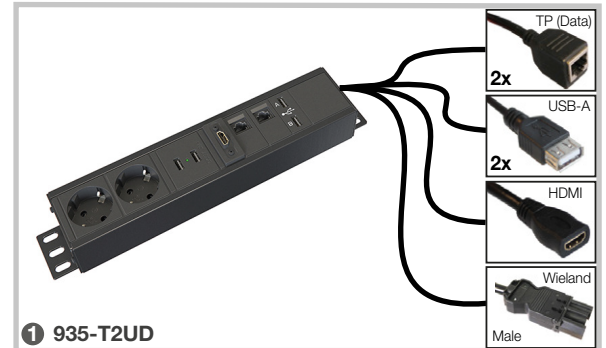

Power cord (Schuko <-> Wieland Female)

Title	Art. No	
1 Power cord (2 m)	935-BA20	
2 Power cord (3 m)	935-BA30	
3 Power cord (5 m)	935-BA50	

Power distributor

Title	Art. No	
1 Power distributor (1 Male to 2 Female)	937-BTK12	
2 Power distributor (1 Male to Female)	937-BTK13	

Extension cord (Wieland Male <-> Wieland Female)

Benämning	Art. No	
1 Extension cord (2 m)	935-BF20	
2 Extension cord (3 m)	935-BF30	
3 Extension cord (5 m)	935-BF50	

Connection diagrams with Axessline outlet strips



Connection example

Connection diagram for 2 workplaces, with 935-T2UD and/or 935-T5UD

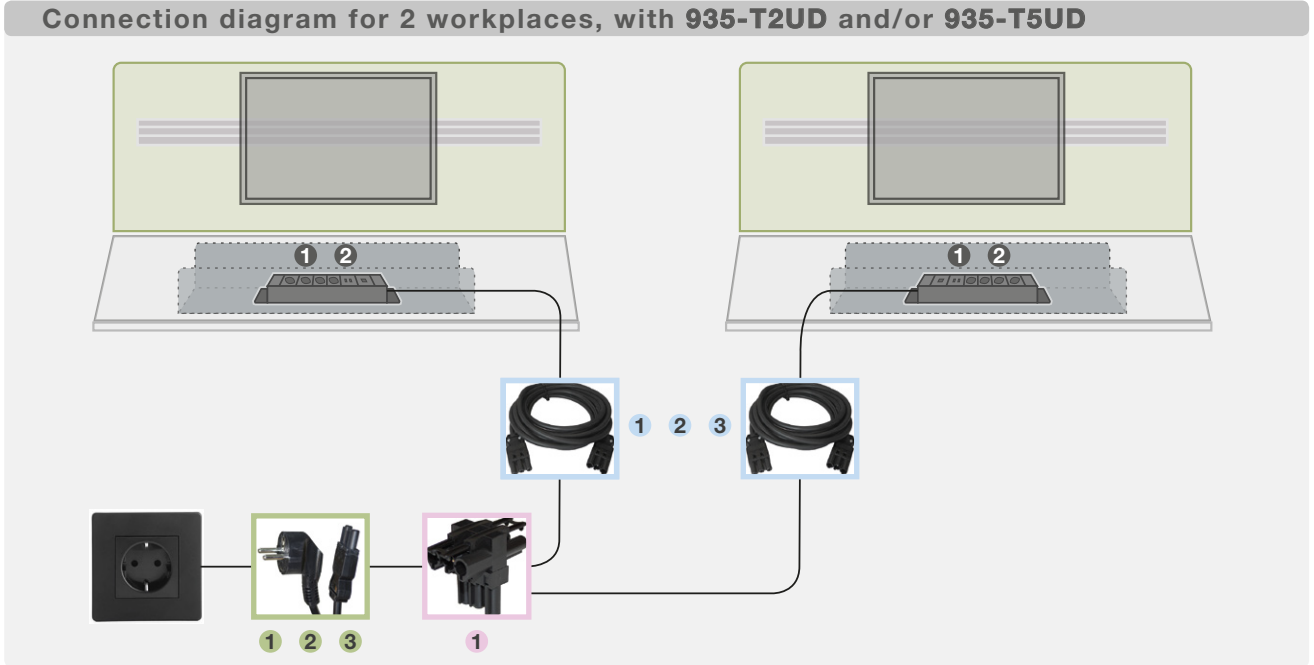

Connection diagram for 3 workplaces, with 935-T2UD and/or 935-T5UD

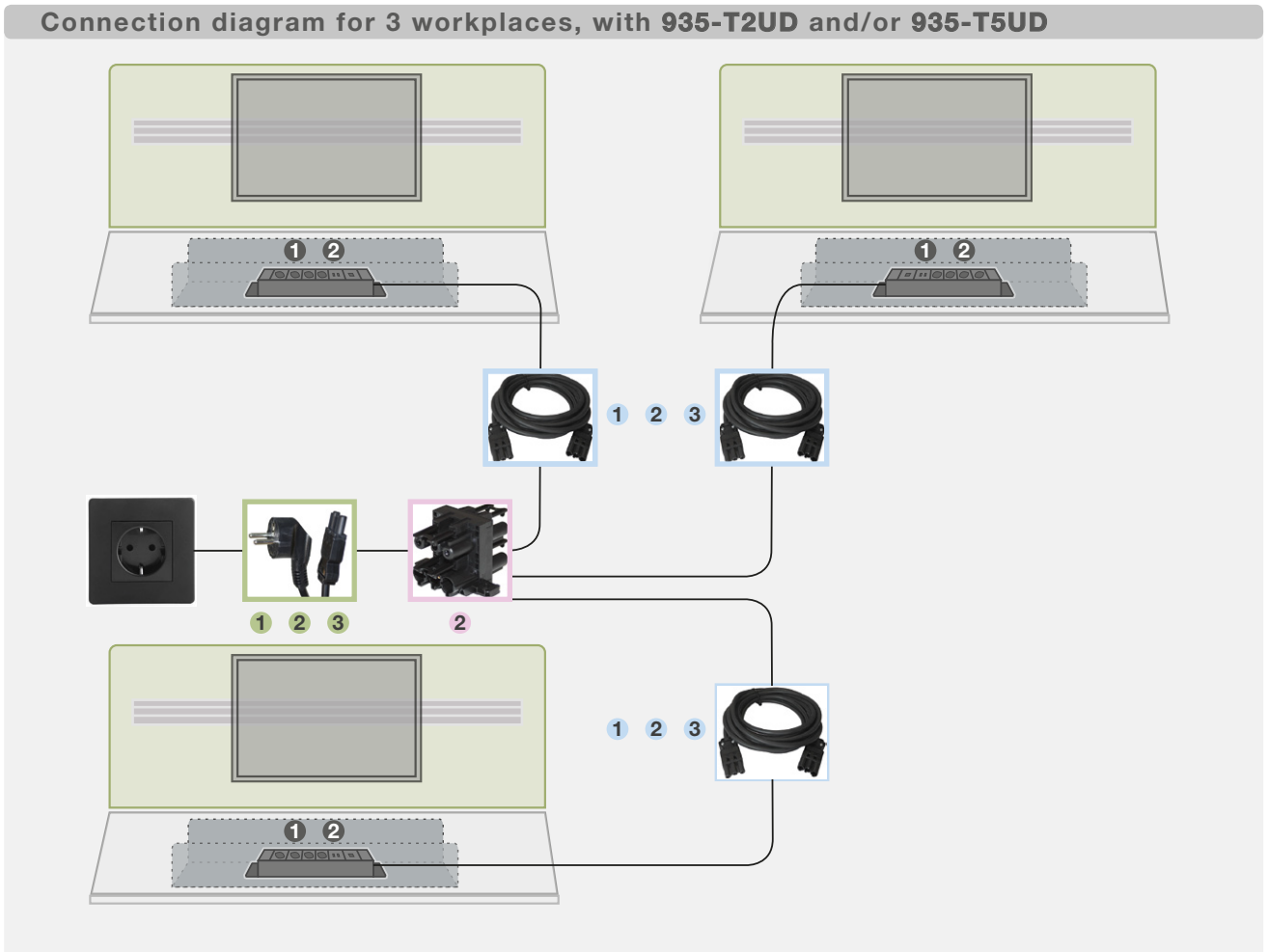

Power cord

Power distributor

Extension cord

Outlet strips*

*Maximum load for Axessline outlet strips: 3500 W

Connection diagrams with Axessline outlet strips



Connection example

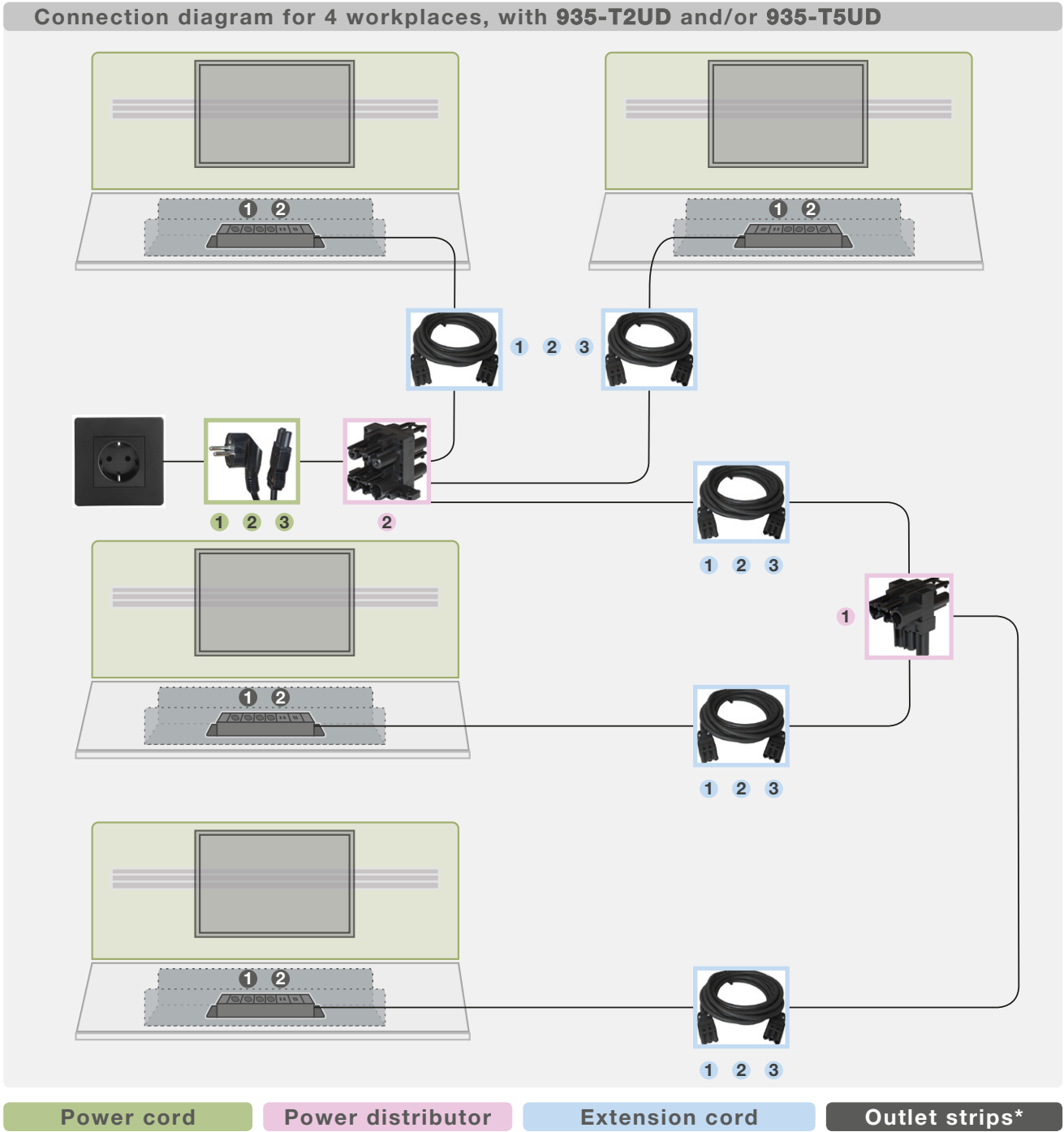

*Maximum load for Axessline outlet strips: 3500 W

Connection diagrams with Axessline outlet strips



Connection example

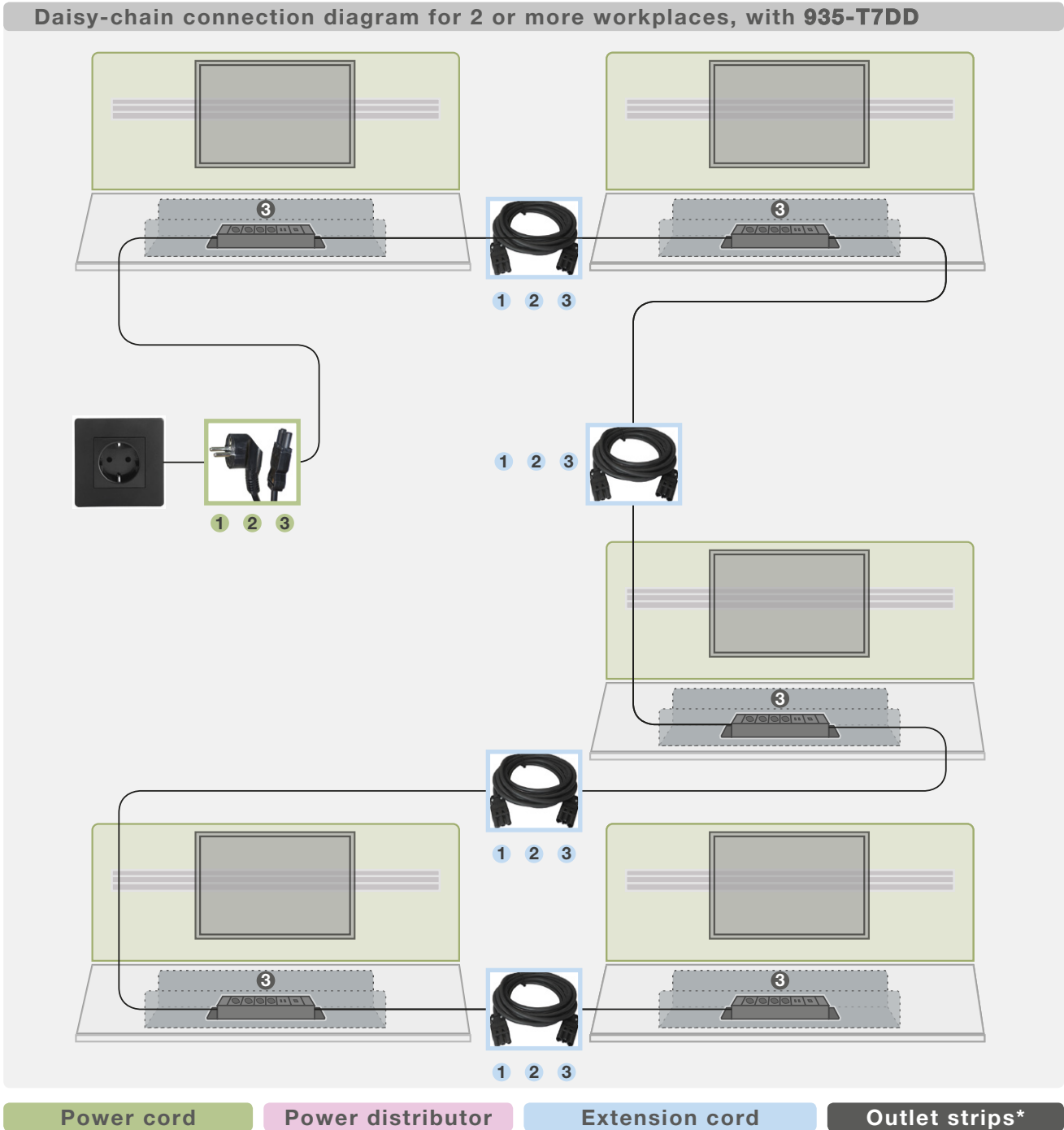

*Maximum load for Axessline outlet strips: 3500 W