

Jabra
Elite 85h



Jabra^{GN}

User manual

© 2019 GN Audio A/S. All rights reserved. Jabra® is a trademark of GN Audio A/S. The Bluetooth® word mark and logos are registered trademarks owned by the Bluetooth SIG, Inc. and any use of such marks by GN Audio A/S is under license.

Made in China
MODEL:OTE100



 **Bluetooth®**

Declaration of Conformity can be found on
www.jabra.com/doc

1. Welcome.....	5
2. Jabra Elite 85h overview.....	6
2.1 Included accessories	
3. How to wear.....	7
4. How to charge.....	8
4.1 Sleep mode	
4.2 What the LED means	
5. How to connect.....	11
5.1 Pair with a smartphone	
5.2 Connect to 3.5mm jack port	
6. How to use	13
6.1 Power on/off	
6.2 Calls & music	
6.3 Voice Assistant	
6.4 Active Noise Cancellation (ANC)	
6.5 HearThrough™	
6.6 Jabra Sound+ Moments	
6.7 Multiuse	
6.8 On-ear detection	
6.9 Multiple call handling	
6.10 Voice guidance	
6.11 Update firmware	
6.12 How to reset	

7. Jabra Sound+ app.....	24
8. Support	25
8.1 FAQ	
8.2 How to care for your headphones	

1. Welcome

Thank you for using the Jabra Elite 85h. We hope you will enjoy it!

Jabra Elite 85h features

- **SmartSound:** audio that automatically adapts to your surroundings.
- **Block unwanted background noise.** Smart Active Noise Cancellation (ANC) for superior sound.
- **Exceptional music clarity.** Purpose-built speakers offer a distinctly sharper music experience.
- **Power through your day.** Get up to 36 hours battery life (ANC on).
- **Unmatched call quality.** 8 microphones for enhanced call quality.
- **One-touch access to your voice assistant.** Instant access to Amazon Alexa, Siri®, and Google Assistant™.
- **Certified rain-resistant durability.** Go anywhere with a 2-year warranty against water and dust.
- **Personalize your headphones.** Pair with the Jabra Sound+ app for SmartSound features, including customizable settings.

2. Jabra Elite 85h overview

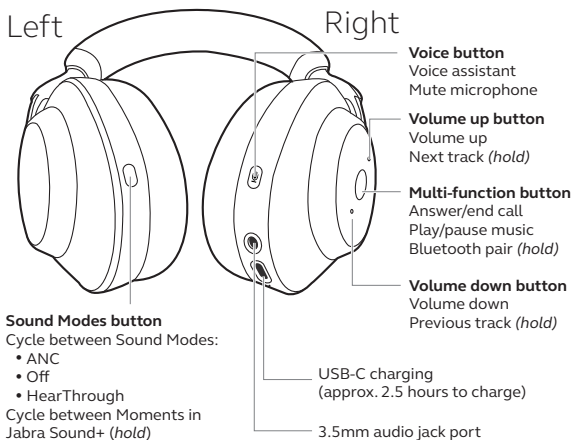

2.1 Included accessories



USB cable



Audio jack cable



Flight adapter



Pouch

3. How to wear

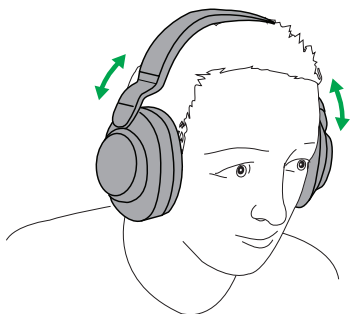

Adjust the headband so that the headphones fit your head comfortably.

4. How to charge

To charge the headphones, connect the USB charging cable to the USB charging port on the right earcup. It is recommended to charge the headphones using the supplied Jabra charging cable, however it is possible to use a compatible charger.

Right earcup

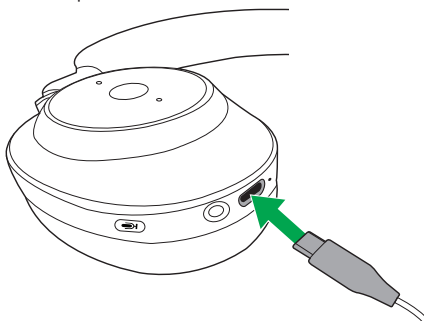

It takes approx. 2.5 hours to fully charge the battery. If the headset is fully out of battery, 15 minutes of charging will give 5 hours of battery.

4.1 Sleep mode

When the headphones are powered on, but not being worn, they will automatically enter sleep mode after 1 hour to conserve battery. To exit sleep mode, simply wear the headphones again, or press any button.



The length of time before the headphones enter sleep mode can be adjusted using the Jabra Sound+ app.

After 24 hours of sleep mode, the headphones will power down completely.

4.2 What the LED means

Right earcup

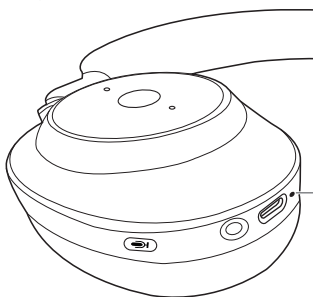

LED

- Power on
- Battery full
- Battery medium
- Battery low
- ⚡ Battery critically low
- Pairing mode
- Resetting/Firmware updating

5. How to connect

5.1 Pair with a smartphone

1. Wear the headphones.
2. Press and hold the **Multi-function** button on the right earcup for 3 seconds until the LED flashes blue and you hear an announcement in the headphones.
3. Go to the Bluetooth menu on your smartphone and select the Jabra Elite 85h from the list of available devices.

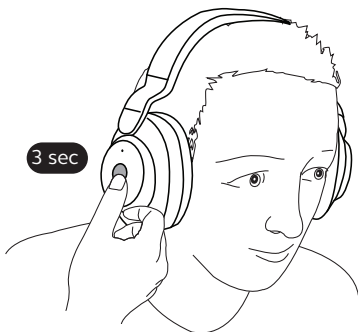

5.2 Connect to 3.5mm jack port

Plug the supplied audio jack cable into the 3.5mm audio jack port on the headphones.

When connected to a device using the audio jack cable, the headset microphone and Bluetooth are disabled. If the headset is plugged into a smartphone, the smartphone's microphone will be used for calls.

The volume and Sound Modes can still be controlled using the buttons on the headphones.

Right earcup

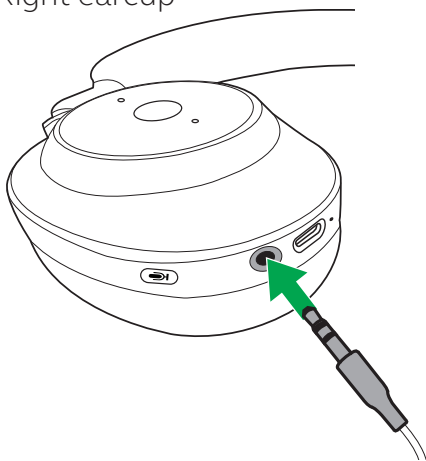

6. How to use

6.1 Power on/off



The headphones automatically power on when the earcups are rotated into the wearing position.



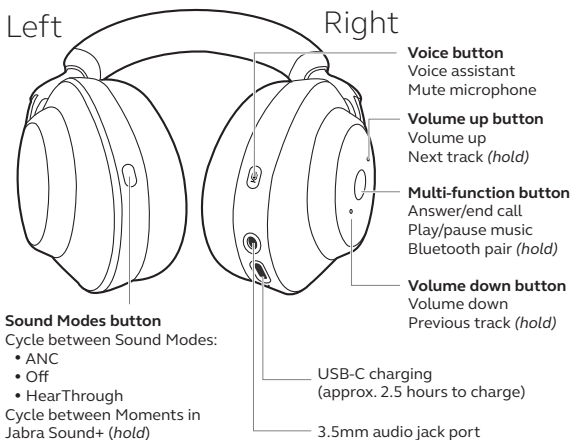

The headphones automatically power off when the earcups are folded flat.

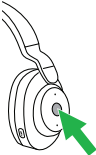

6.2 Calls & music

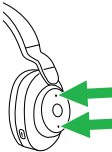
Right	Calls & music
	<p>Play/pause music</p> <p>Press the Multi-function button</p>
	<p>Answer call</p> <p>Press the Multi-function button, or say 'Answer'</p>
	<p>End call</p> <p>Press the Multi-function button</p>
	<p>Reject call</p> <p>Double-press the Multi-function button, or say 'Ignore'</p>

Adjust volume	Press the Volume up or Volume down button, when listening to music or on a call
Next track	Press and hold (1 sec) the Volume up button
	Restart track
Hear battery and connection status	<p>Press and hold (1 sec) the Volume down button to restart the current track.</p> <p>Press and hold twice to play the previous track.</p> <p>Press the Volume up or Volume down button, when not listening to music or on a call</p>
	<p>Activate Voice Assistant (i.e. Siri, Google Assistant, Amazon Alexa or Baidu)</p> <p>Mute/un-mute microphone</p>
<p>Press the Voice button, when not on a call</p> <p>Press the Voice button, when on a call</p>	

Left

Sound Modes



Cycle between
Sound Modes:
ANC, Off,
HearThrough

Press the **Sound Modes**
button

Cycle between
Moments in
Jabra Sound+

Press the **Sound Modes**
button

6.3 Voice Assistant

The Jabra Elite 85h enables you to speak to Siri, Google Assistant, Amazon Alexa or Baidu on your smartphone using the **Voice** button.

Right

Voice Assistant



Activate Voice
Assistant (i.e.
Siri, Google
Assistant,
Amazon Alexa
or Baidu)

Press the **Voice**
button, when not
on a call

6.4 Active Noise Cancellation (ANC)

Active Noise Cancellation (ANC) counters noise. It detects and analyzes the pattern of incoming sound, and then generates an anti-noise signal to cancel it out. As a result, you experience a drastically reduced level of surrounding noise.

ANC settings can be configured using the Jabra Sound+ app.

Left

ANC



Turn on ANC

Press the **Sound Modes** button to cycle through the available Sound Modes until ANC is announced.

6.5 HearThrough™

HearThrough utilizes the built-in microphones to enable you to pay attention to your surroundings and engage in conversation without needing to remove the headphones.

HearThrough settings can be configured using the Jabra Sound+ app.

Left

HearThrough



Turn on
HearThrough

Press the **Sound Modes** button to cycle through the available Sound Modes until HearThrough is announced.

6.6 Jabra Sound+ Moments

Moments are predefined audio configurations in the Jabra Sound+ app that are designed to suit the different moments of your day.

Left	Moments
	<p data-bbox="332 574 521 716">Cycle through Moments in the Jabra Sound+ app</p> <p data-bbox="586 558 907 733">Press and hold (1 sec) the Sound Modes button to cycle through the available Moments in the Jabra Sound+ app</p>

6.7 Multiuse

The headphones can be paired to two smartphones at once, and can accept multiple incoming calls from either smartphone.

To pair to two smartphones, use the normal pairing process separately for each smartphone (refer to section 5).

Note: Voice assistant will be activated on the last paired smartphone.

6.8 On-ear detection

The headphones have built-in sensors that can detect when the headphones are being worn.

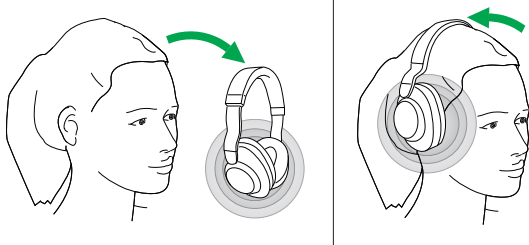

AUTO-PAUSE MUSIC

When listening to music, removing the headphones will automatically pause the music. Wear the headphones again to automatically resume the music.

MUTE CALL

When you are on a call, removing the headphones will automatically mute the call. Wear the headphones again to automatically un-mute the call.

This feature is off by default, and can be enabled in Jabra Sound+.

AUTO-ANSWER INCOMING CALL

When the headphones are not being worn and you have an incoming call, wearing the headphones will automatically answer the call.

This feature is off by default, and can be enabled in Jabra Sound+.

6.9 Multiple call handling

The headphones can accept and handle multiple calls at the same time.

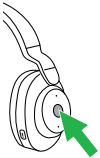
Right	Multiple call handling	
	End current call and answer incoming call	Press the Multi-function button
	Put current call on hold and answer incoming call	Hold (2 secs) the Multi-function button
	Switch between held call and active call	Hold (2 secs) the Multi-function button
	Reject incoming call, when on a call	Double-press the Multi-function button

6.10 Voice guidance

Voice guidance are announcements intended to guide you through set up, or to give you headphone status updates (e.g. connection and battery status).

Voice guidance is enabled by default.

Right	Voice guidance
	<p>Turn Voice guidance on/off</p> <p>Press and hold (5 sec) the Voice button until you hear an announcement in the headphones.</p>

Alternatively, use the Jabra Sound+ app on your smartphone to turn Voice guidance on or off.

For the latest list of supported languages, refer to the Jabra Sound+ app.

6.11 Update firmware

Firmware updates improve performance, or add new functionality to Jabra devices.

Download the Jabra Sound+ app for firmware updates.

6.12 How to reset

Resetting the headphones clears the list of paired devices and resets all settings.

Right

Reset headphones



Reset pairing list and settings

Ensure the headphones are powered on and you are not on a call. Then simultaneously press and hold (5 sec) the **Volume up** button and the **Multi-function** button until the LED lights up purple and you hear an announcement in the headphones.

You will need to re-pair the headphones to your smartphone.

7. Jabra Sound+ app



Jabra Sound+ app



Customize your music



Manage HearThrough and Active Noise Cancellation



Register your 2-year warranty



8. Support

8.1 FAQ

View the FAQs on Jabra.com/help/elite85h.

8.2 How to care for your headphones

- Always store the headphones in the supplied case.
- To prevent the depletion of the battery lifetime or capacity, avoid storing the headphones in hot or cold environments, such as a closed car in summer, or in winter conditions.
- When exposed to rain, allow the headphones sufficient time to dry. It may take up to one hour for the headphones to dry thoroughly and power on.
- It is recommended to keep the headphones between 15°C and 25°C (59°F and 77°F).
- Do not store the headphones for extended periods of time without recharging them (max. three months).

jabra.com/elite85h

REV.A