



## MAVIC™ 2 MOUNT INSTALLATION

Read installation instructions to ensure mounting is secure. Incorrect installation can lead to drone operation error. Lume Cube cannot be held liable for drone damage.



**REVERSE SIDE FOR INSTRUCTIONS**

***Liability Disclaimer: Lume Cube is not liable for any damage to drone caused by operator error or incorrect mounting to drone.***

1

Make sure the tension disk is screwed onto the 1/4" 20 screw on the mounts (figure 1). You will use this to angle your Lume Cube in the desired direction.

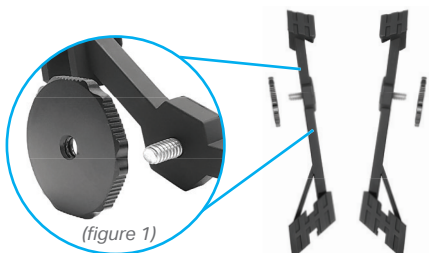

2

Mount your Lume Cubes to your Mavic 2 Mounts prior to mounting them on the drone. Simply screw your Lume Cubes onto the screw on each mount (figure 1). Angle your lights in the desired direction, and then spin the tension disk counter clockwise (figure 2) until it tightens on the base of the Lume Cube.

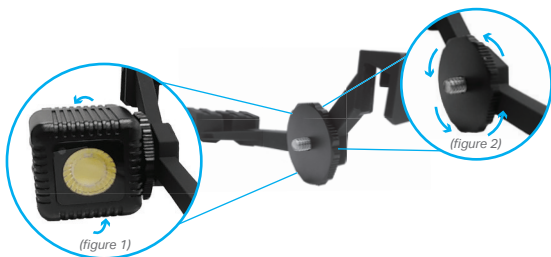

3

Prior to mounting your lighting kit to the drone, make sure each mount is on the correct side by ensuring the buttons on your Lume Cubes are facing away from the drone, and the Lume Cube logos on the drone mounts are facing the body of the drone.

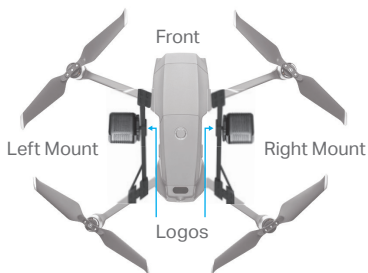

4

Mounting to the drone: Locate the triangular notch on the front of the Mavic 2 Mounts (figure 1) and line it up with the similar shaped cavity on the Mavic 2 (figure 2). This part of the mount will be installed on the drone first.

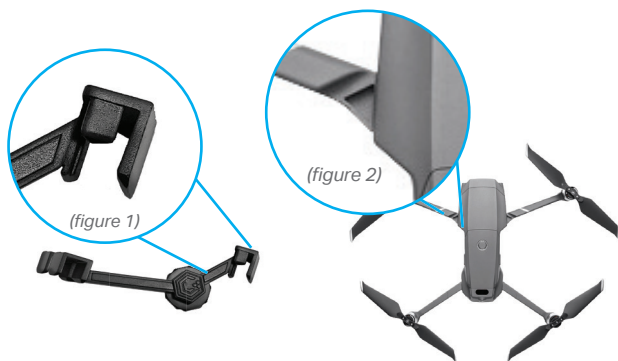

5

Press down on the front of the Mavic 2 Mounts to fit the triangular notch into the similar shaped cavity on the Mavic 2 drone. This should be a tight fit.

***\*Note: Ensuring the triangle is lined up and firmly pressed down into the triangular shaped cavity is integral for safe flying.***

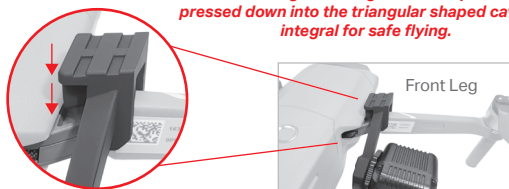

Incorrect  
(Will not clear propeller)



Correct

6

Once the front of the mount is installed, push down on the back legs of the Mavic 2 Mounts to securely attach the mounts to the back legs of the drone. Ensure they are fully pushed down secure. Finally, firmly press down on the mounts to ensure a snug fit.



7

Install the **Locking Clips**: Lock your Mavic 2 Mounts into place with the 2 included Locking Clips. Position your Locking Clips underneath the back of the Mavic 2 Mounts. Firmly push up on the Locking Clip to secure your Mounts around the back legs of the drone (*figure 1*). You will hear a click when the Locking Clip is in place (*figure 2*).

(figure 1)

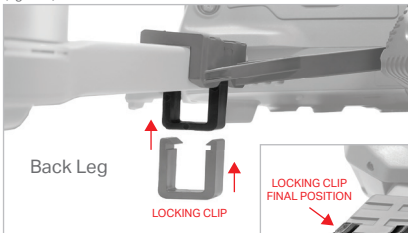

(figure 2)

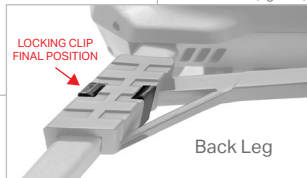

8

Happy flying!

For Video Instructions visit: [www.lumecube.com/mavic2installation](http://www.lumecube.com/mavic2installation)

Scan me for  
video instruction



**\*Liability Disclaimer: Lume Cube is not liable for any damage to drone caused by operator error or incorrect mounting to drone.**