

VOXICON

VOXICON SOUNDBAR VXA-656
3.1 DOLBY ATMOS + SUB

VXA-S108



User Manual

Please read this manual carefully for proper usage before Installation and use. It is recommended to keep this manual for future check. The pictures in this manual are only for reference.

PACKAGE CONTENTS



Soundbar

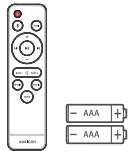

Remote Control /
AAA Batteries x 2

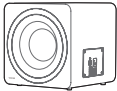

Wireless Subwoofer



HDMI Cable

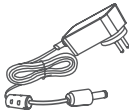

AC Adapter
[for Soundbar]



AC Power Cord
[for Subwoofer]



Wall mount kit

* Power cord quantity and plug type vary by regions.

Images, illustrations and drawings shown on this User Manual are for reference only, actual product may vary in appearance.

PRODUCT OVERVIEW

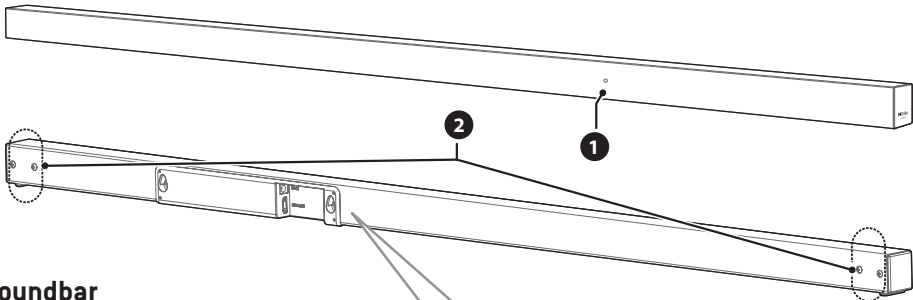

Soundbar

- ① LED Indicators /
Remote Control Sensor

LED	Mode
● Red	Standby
● White	HDMI eARC/ARC
● Blue	BT (Bluetooth)

- ② Wall bracket screws
③ HDMI eARC/ARC Socket
④ DC~ Socket

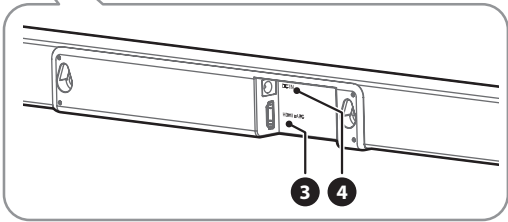



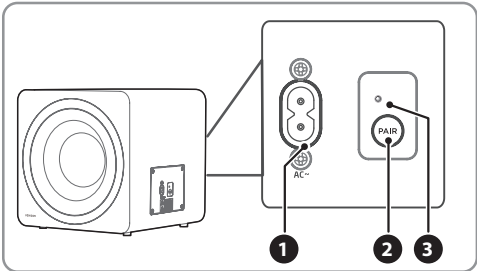

Wireless Subwoofer

- ① AC~ Socket
② PAIR button
③ PAIR Indicator



REMOTE CONTROL

①		Switch the soundbar between ON and Standby mode.
②		Select the Bluetooth mode. Activate the pairing function in Bluetooth mode or disconnect the existing paired Bluetooth device.
③	HDMI	Select the HDMI eARC/ARC mode.
④	+/-	Increase / decrease the volume level.
⑤		Skip to previous / next track.
⑥		Play / pause / resume playback.
⑦	BASS + BASS -	Adjust bass level.
⑧		Mute or resume the sound.
⑨	MOVIE MUSIC NEWS	Select Equalizer [EQ] Effect.

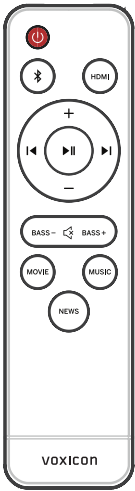

Preparations Remote Control

- Open the rear cover & insert 2pcs AAA/R03, 1.5V batteries on correct polarity.
- Take out batteries if remote is not to be used in long time to avoid battery leakage.

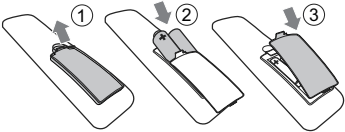

EXCEPT BT CONNECTION, AUDIO INPUT CAN BE WITH HDMI CABLE

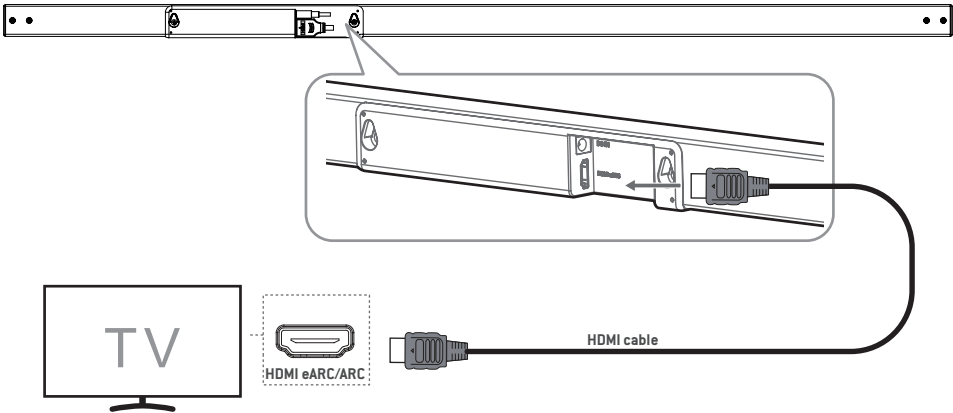

PLACEMENT AND MOUNTING

Placement

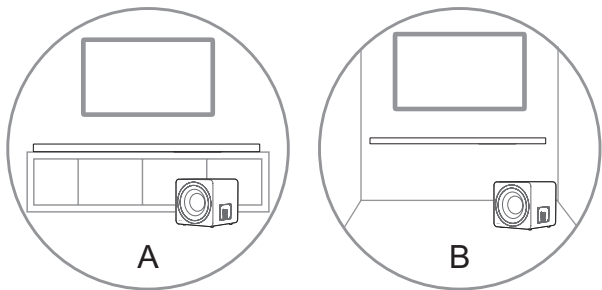

Wall Mounting (if using option-B)

NOTE: If you are unfamiliar with power tools or the layout of electrical wiring in the walls of your home, consult a professional installer.

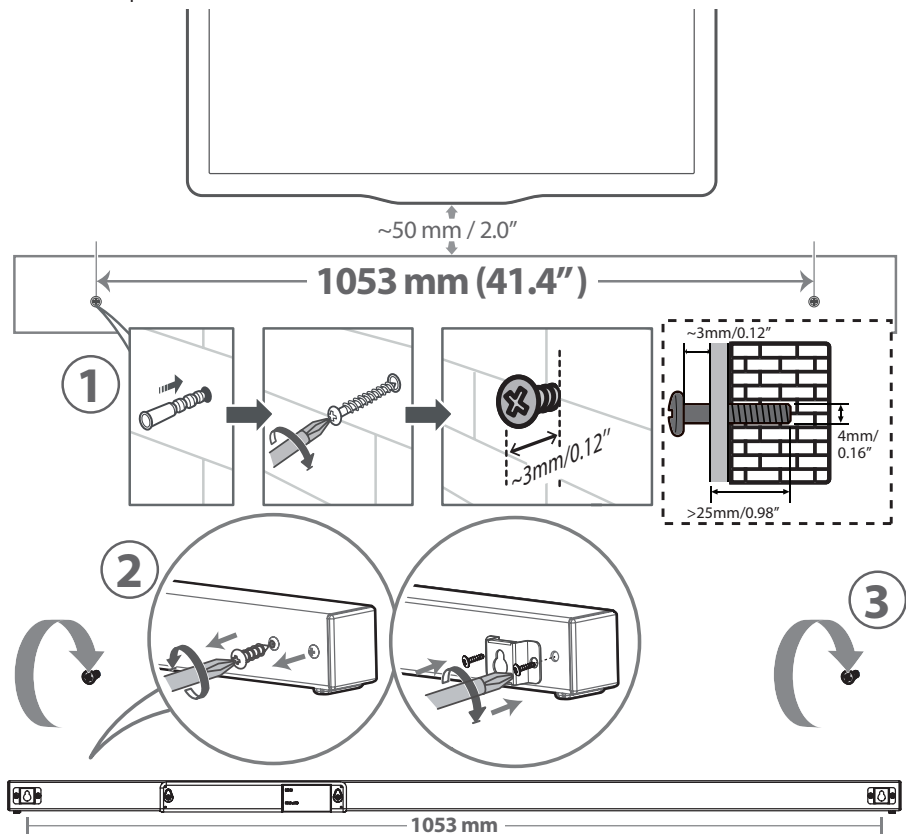

Pair up with the Subwoofer

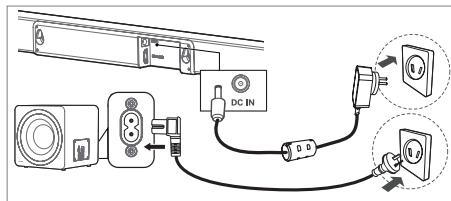

1. Soundbar: Insert the AC Adapter into the **DC IN** jack and switch on the soundbar. The soundbar will start searching the subwoofer signal automatically.
 2. Subwoofer: Insert the AC power cable into the **AC-IN** jack and switch on. The subwoofer will connect the soundbar automatically.
 3. The subwoofer indicator will constant on once it's connected successfully.
 4. The two devices will automatically be connected in next time.
- Determine the status based on the wireless Subwoofer indicator.

LED State	Status
Fast blink	Subwoofer in pairing mode
Constant on	Connected / Pairing successful
Slow blink	Connection / Pairing Failed

NOTE:

- Don't press **PAIR** button as Bar and Subwoofer would be paired automatically after the unit is switched ON.
- In case of a problem, press and hold the **PAIR** button on the subwoofer then press and hold the **MUTE** button on the remote control to manually pair.

Automatic Power Off Function

The unit automatically turns to **Standby** mode after about **15** minutes if the TV or the external unit is disconnected, switched off.

Dolby Atmos®

This soundbar is equipped with a decoder that supports Dolby Atmos audio format.

Dolby Atmos® gives you immersive listening experience by delivering sound in three dimensional space, and all the richness, clarity, and power of Dolby sound. For more information, please visit dolby.com/technologies/dolby-atmos

HDMI eARC Operation

1. Ensure that the soundbar is connected to the TV or audio device.
2. Press the **HDMI** button on the remote control to select the **HDMI** mode.
3. Operate your audio device directly for playback features.
4. Press the **VOL + / -** button to adjust the volume to your desired level.

Bluetooth® Operation

Pairing the soundbar with a Bluetooth® device to listen to music:

First time pairing

1. Press the **Bluetooth** button on the remote control to select Bluetooth® mode. The Blue indicator will flash slowly.
2. On the Bluetooth device, switch on Bluetooth, search for and select **VXA-S108** to start connection.
3. Wait until you hear the voice prompt from the soundbar.
4. Select and play audio files or music on your Bluetooth device.

Pairing a new device after first time pairing:

press and hold the **Bluetooth** button on the remote control to disconnect from current Bluetooth connected devices and enter the Bluetooth pairing mode. Follow step 2-3 to pair your Bluetooth® device.

Note:

- Compatibility with all Bluetooth® devices is not guaranteed.

TROUBLESHOOTING



To keep the warranty valid, never try to repair the system yourself. If you encounter problems when using this soundbar, check the following points before requesting service.

Problem	Solution
No power	<ul style="list-style-type: none"> • Ensure that the AC cord of the apparatus is properly connected . • Ensure that there is power at the AC outlet. • Press ⏻ (standby) button to turn the soundbar on.
Remote control does not work	<ul style="list-style-type: none"> • Before you press any playback control button, first select the correct source. • Reduce the distance between the remote control and the soundbar. • Insert the battery with its polarities ⊕/⊖ aligned as indicated. • Replace the battery. • Aim the remote control directly at the sensor on the front of the soundbar.
No sound	<ul style="list-style-type: none"> • Make sure that the soundbar is not muted. Press MUTE or volume +/- button to resume normal listening. • Press ⏻ button to switch the soundbar to standby mode. Then press the ⏻ button again to switch the soundbar on. • Unplug both the soundbar and the subwoofer from the mains socket, then plug them again. Switch on the soundbar. • Ensure the audio setting of the input source (e.g. TV, game console, DVD player, etc.) is set to PCM or Dolby Digital mode while using digital (e.g. HDMI) connection. • The subwoofer is out of range, please move the subwoofer closer to the soundbar. Make sure the subwoofer is within 5 m of the soundbar (the closer the better). • The soundbar may have lost connection with the subwoofer. Re-pair the units by following the steps on the section "Pair up with the Subwoofer". • The soundbar may not be able to decode all digital audio formats from the input source. In this case, the soundbar will mute. This is NOT a defect. device is not muted.
TV has display problem while viewing HDR content from HDMI source.	<ul style="list-style-type: none"> • Some 4K HDR TVs require the HDMI input or picture settings to be set for HDR content reception. For further setup details on HDR display, please refer to the instruction manual of your TV.
I can't find the Bluetooth name of this soundbar on my Bluetooth device for Bluetooth pairing	<ul style="list-style-type: none"> • Ensure the Bluetooth function is activated on your Bluetooth device. • Re-pair the Soundbar with your Bluetooth device. • The Soundbar has a Bluetooth® function that can receive a signal within 8 metres. Keep a distance within 8 metres between the Soundbar and your Bluetooth® device.
The Soundbar turns off	<ul style="list-style-type: none"> • When the Soundbar's external input signal level is too low, the Soundbar will be automatically turn off after 15 minutes. Please increase the volume level of your external device.
Can't achieve outstanding Dolby Atmos® effects.	<ul style="list-style-type: none"> • For non-HDMI connections (such as use of Bluetooth), limited height Surround effects are generated. See the section of "Dolby Atmos®" about how to achieve best Dolby Atmos® effects.

SPECIFICATIONS

Brand	VOXICON
Model	VXA-S108

Soundbar

Adapter Mode	KA4801A-2402000 AU
Input	100-240V~ 50/60Hz, 1.2A (Max)
Output	24V \approx 2.0A  (Use only the power supplies listed in the user manual.)  
Power Consumption	40 W < 0.5 W (StandBy)
Dimension (WxHxD)	1100 × 40 × 34.5 mm
Net weight	1.0 kg
Frequency Response	120Hz - 20KHz

Wireless Specification

Bluetooth version / profiles	V 5.3 (A2DP, AVRCP)
Bluetooth frequency range	2400 MHz ~ 2483.5 MHz
Bluetooth Max. transmitting power	≤ 5 dBm
2.4G Wireless frequency range	2400 MHz ~ 2483 MHz
2.4G Max. transmitting power	≤ 6 dBm
Modulation Type	GFSK, $\pi/4$ DQPSK

Subwoofer

Power Supply	100-240V~ 50/60Hz
Power Consumption	40 W < 0.5 W (StandBy)
Dimension (WxHxD)	250 × 255 × 253 mm
Net weight	4.7 kg
Frequency Response	40Hz - 120Hz

Amplifier (RMS Output power)

Total	420 W Maximum/Peak/Reference/Music Power (approx.) 210 W (RMS Power @ 10% THD (W))
Soundbar	30W x3
Subwoofer	120W

Remote Control

Distance/Angle	19.7 feet (6m) / 30°
Battery type	AAA (1.5V x 2)

- Design and specifications are subject to change without notice.

CARE AND MAINTENANCE

1. Do not subject the unit to excessive force, shock, dust or extreme temperature.
2. Do not tamper with the internal components of the unit.
3. Clean the unit with a damp [never wet] cloth except metal contact or speaker grille. Solvent or detergent should never be used.
4. Avoid leaving your unit in direct sunlight, humid or dusty or extreme cold/hot places. Keep your unit away from heating appliances and sources of electrical noise.
5. Do not install or place this unit in a bookcase, built-in cabinet or coned space. Ensure the unit is well ventilated.
6. Un-plug the unit from the mains socket after used or lightning storm or while cleaning.
7. Do not open any xed covers as this may expose dangerous voltages.

CAUTION: Never allow any water or other liquids to get inside the unit while cleaning.



This symbol on the product or in the instructions means that your electrical and electronic equipment should be disposed at the end of its life separately from your household waste. There are separate collection systems for recycling in the EU. For more information, please contact the local authority or your retailer where you purchased the product.



Notes for battery disposal

The batteries used on remote control contain chemicals that are harmful to the environment. To preserve our environment, dispose of used batteries according to your local laws or regulations. Do not dispose of batteries with normal household waste.

For more information, please contact the local authority or your retailer where you purchased the product.



The Bluetooth® word mark and logos are registered trademarks owned by Bluetooth SIG, Inc. and any use of such marks by **VOXICON** is under license. Other trademarks and trade names are those of their respective owners.

The terms HDMI, HDMI High-Definition Multimedia Interface, HDMI trade dress and the HDMI Logos are trademarks or registered trademarks of HDMI Licensing Administrator, Inc.

Dolby, Dolby Atmos, and the double-D symbol are registered trademarks of Dolby Laboratories Licensing Corporation. Manufactured under license from Dolby Laboratories. Confidential unpublished works. Copyright © 2012-2024 Dolby Laboratories. All rights reserved.



20302xxxx