



P/N: 15G065255000AK V1.0

### Quick Installation Guide

**Z690D4U-2L2T/G5 | W680D4U-2L2T/G5 | Z690D4U/G5 | Z690D4U-2L2T/G5/BCM | W680D4U-2L2T/G5/BCM**



www.asrockrack.com



Z690D4U-2L2T/G5



W680D4U-2L2T/G5



Z690D4U/G5



Z690D4U-2L2T/G5/BCM



W680D4U-2L2T/G5/BCM

The server board User's Manual is available for download from the ASRock Rack's official website at <http://www.asrockrack.com>.

Take note of the following precautions before you install server board components or change any server board settings.

1. Unplug the power cord from the wall socket before touching any components.
2. To avoid damaging the server board's components due to static electricity, NEVER place your server board directly on the carpet or the like. Also remember to use a grounded wrist strap or touch a safety grounded object before you handle the components.
3. Hold components by the edges and do not touch the ICs.
4. Whenever you uninstall any component, place it on a grounded anti-static pad or in the bag that comes with the component.
5. When placing screws into the screw holes to secure the server board to the chassis, please do not over-tighten the screws! Doing so may damage the server board.

## 1 Install the Server Board

Insert the server board into the chassis.

Affix the screws clockwise into the mounting holes in all of the corners of the server board.

Do not over-tighten the screws.

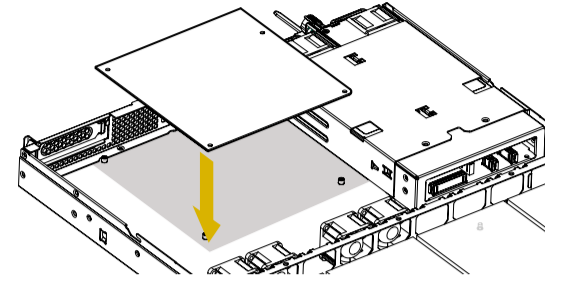

## 2 Motherboard Layout

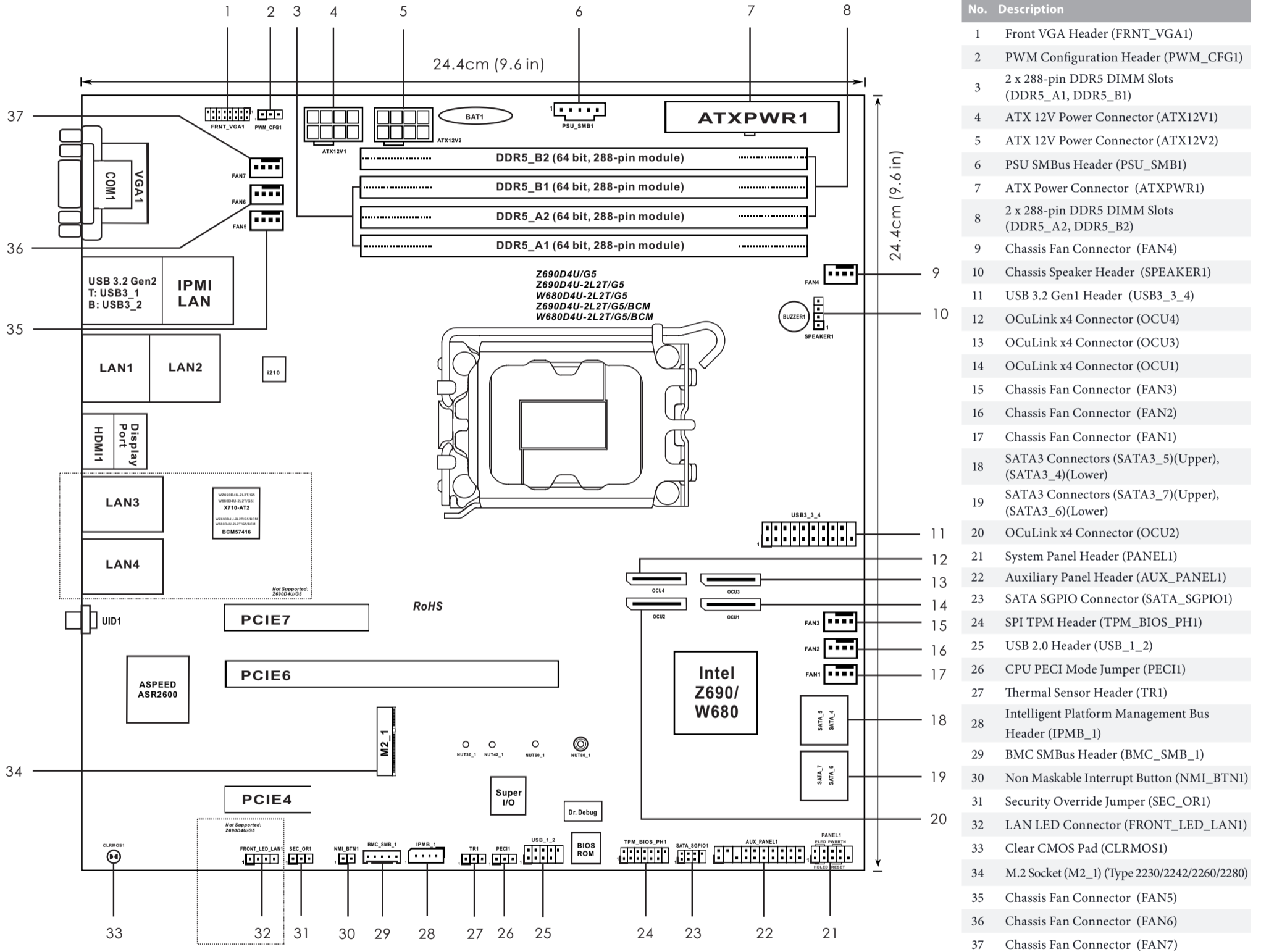

## 3 I/O Panel

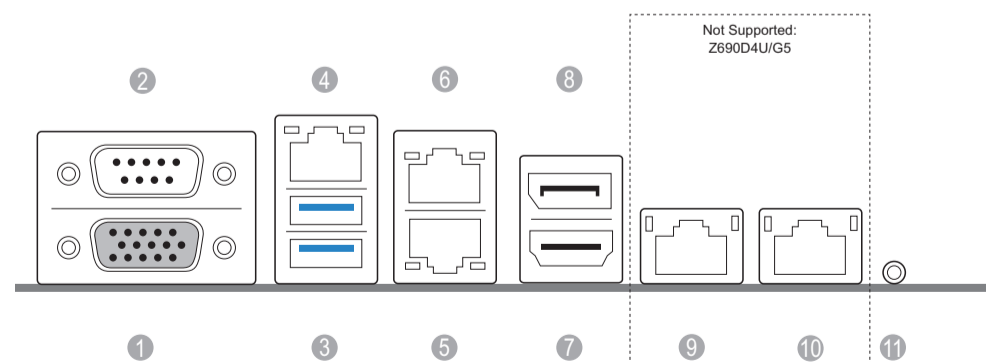

No.	Description	No.	Description
1	VGA Port (VGA1)	7	HDMI Port (2.0b)
2	Serial Port (COM1)	8	Display Port (1.4a)
3	USB 3.2 Gen1 Ports (USB3_1_2)	9	10G LAN RJ-45 Port (LAN3)
4	LAN RJ-45 Port (IPMI_LAN)	10	10G LAN RJ-45 Port (LAN4)
5	1G LAN RJ-45 Port (LAN1)	11	UID Switch (UID1)
6	1G LAN RJ-45 Port (LAN2)		

## 4 LAN Port LED Indications

IPMI LAN Port		Activity / Link LED		Speed LED	
Status	Description	Status	Description	Status	Description
Off	No Link	Off	No Link	Off	10M bps connection or no link
Blinking Yellow	Data Activity	Yellow	Data Activity	Yellow	100Mbps connection
On	Link	Green	Link	Green	1Gbps connection

10G LAN Port		Activity / Link LED		Speed LED	
Status	Description	Status	Description	Status	Description
Off	No Link	Off	No Link	Off	100Mbps connection or no link
Blinking Green	Data Activity	Yellow or Amber	Data Activity	Yellow or Amber	1Gbps connection
On	Link	Green	Link	Green	10Gbps connection

1G LAN Port		Activity / Link LED		Speed LED	
Status	Description	Status	Description	Status	Description
Off	No Link	Off	No Link	Off	10Mbps connection or no link
Blinking Orange	Data Activity	Yellow	Data Activity	Yellow	100Mbps connection
On	Link	Green	Link	Green	1Gbps connection



**5** Install the Processor

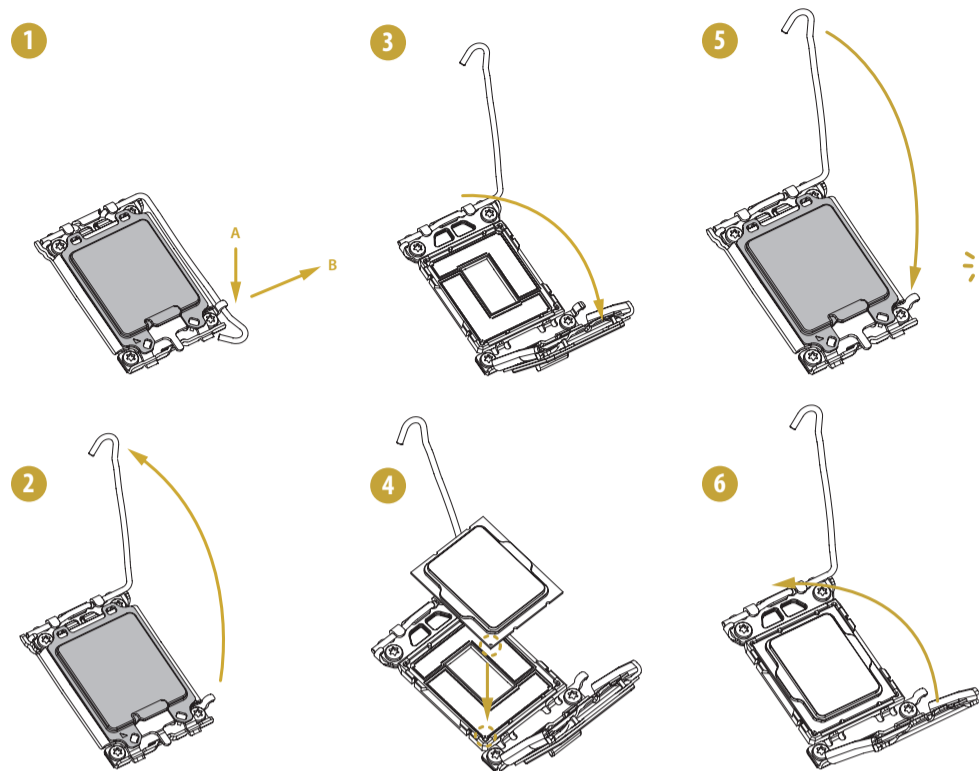

We recommend using the CPU Installation tool to avoid CPU pin-bent problem.  
The illustrations in this quick installation guide are for references only. The actual looks may differ by the actual product you use.

**6** Install the CPU Fan and Heatsink

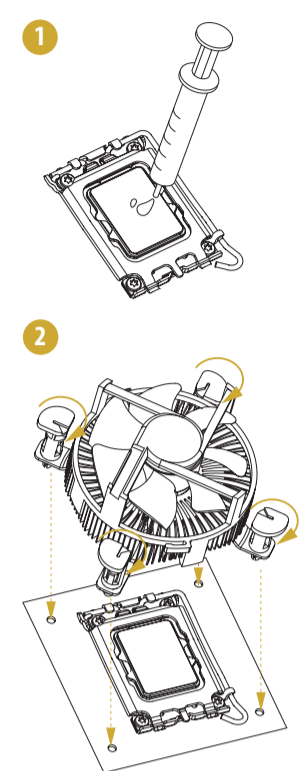

**7** Install the PCIe Card

- 1 Remove the bracket facing the slot that you intend to use. Keep the screw for later use.
- 2 Align the card connector with the slot and press firmly until the card is completely seated on the slot.
- 3 Fasten the card to the chassis with the screw.

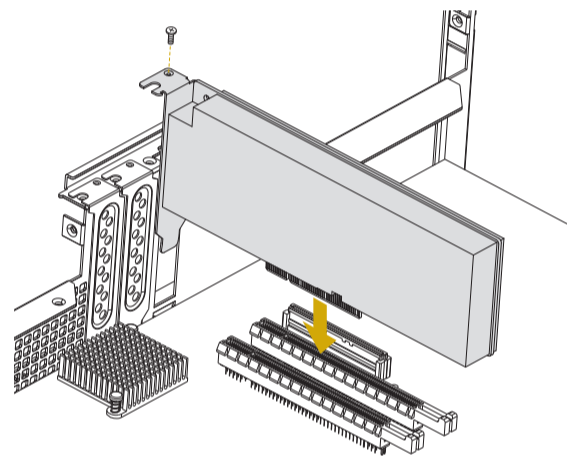

PCIe Slots

Slot	Generation	Mechanical	Electrical	Source
PCIe 7	4.0	x4	x4	CPU
PCIe 6	5.0	x16	x16	CPU
PCIe 4	3.0	x1	x1	PCH

**10** Install the Memory

- 1 Unlock a DIMM slot by pressing the module clips outward.
- 2 Insert the memory module.
- 3 Lock the clips.

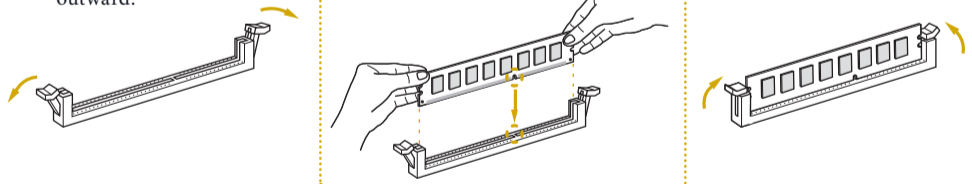

**11** Jumper Cap On/Off

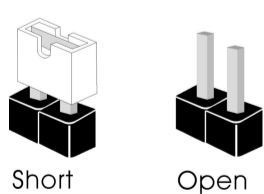

When the jumper cap is placed on the pins, the jumper is "Short". If no jumper cap is placed on the pins, the jumper is "Open".

The illustration shows a 3-pin jumper whose pin1 and pin2 are "Short" when a jumper cap is placed on these 2 pins.

**8** Install the Power Cables

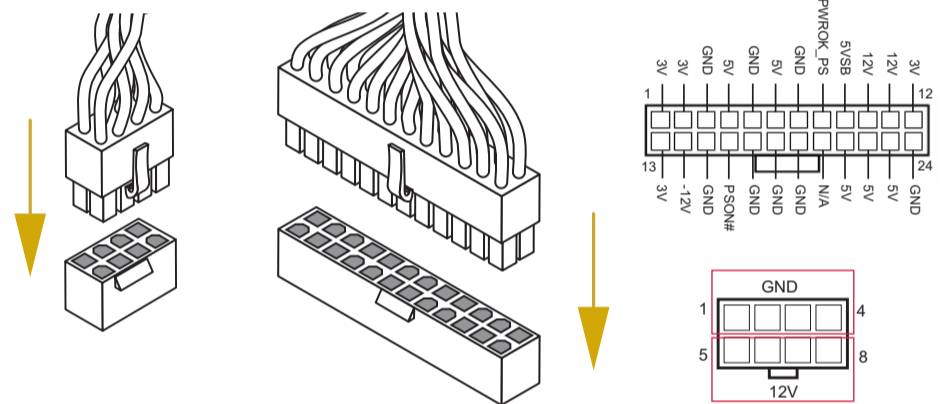

**9** M.2 SSD Module Installation

- 1 Find the corresponding nut location to be used.

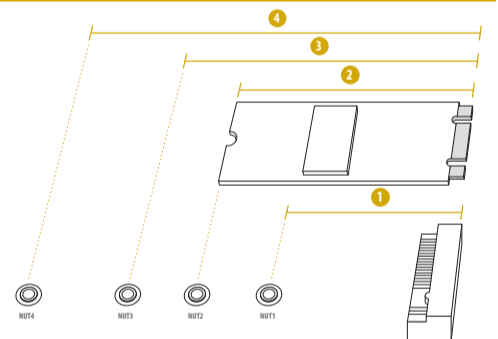

No.	1	2	3	4
Nut Location	NUT1	NUT2	NUT3	NUT4
PCB Length	3cm	4.2cm	6cm	8cm
Module Type	Type 2230	Type 2242	Type 2260	Type 2280

- 2 Move the standoff based on the module type and length.

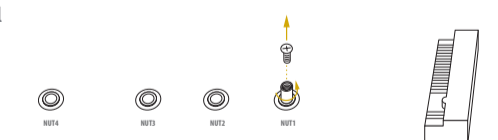

- 3 Peel off the yellow protective film on the nut. Hand tighten the standoff into the desired location.



- 4 Align and gently insert the M.2 module into the slot.

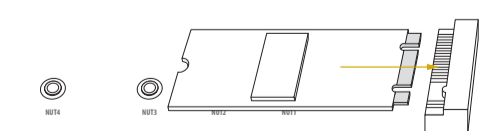

- 5 Tighten the screw with a screwdriver to secure the module into place. Please do not overtighten the screw.

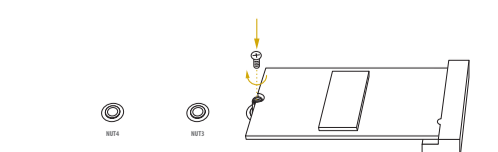

The terms HDMI® and HDMI High-Definition Multimedia Interface, and the HDMI logo are trademarks or registered trademarks of HDMI Licensing LLC in the United States and other countries.