



MU5120

5G Mobile Hotspot

MU5120 is a ZTE third-generation enhanced 5G portable router that supports the latest 5G NR Rel.16 technologies and integrates Wi-Fi6, an extra-large battery, a touchscreen, and forward/reverse charging functions. It enables users to smoothly connect to 5G networks anytime & anywhere on pads, mobile phones, laptops, and control consoles, allowing incredible new experience in ARs, cloud games, and 4K videos.

Benefits

Ultra-high-speed internet connection









With its compact single-chip architecture, MU5120 achieves ultra-high performance-to-cost ratio, with a 5G NR download rate of 2.716Gbps, and Wi-Fi 6 downlink rate of AX3600, demonstrating the ultra-high rate and ultra-low latency of 5G networks end to end.

Long battery life and reverse charging function

MU5120 has an extra-large battery of 10000mAh capacity and can support up to 16 hours *** of continuous web surfing. It can also act as a power bank to reverse charge mobile phones, tablets, and other devices to eliminate users' endurance anxiety.

Rich combinations to exploit the potential of spectrum

MU5120 supports global mainstream 3G/4G/5G frequency bands and combinations such as NR CA and Multi-band ENDC, making full use of operators' existing spectrum resources, and providing users with high-speed, wide-coverage, and smooth-handover cellular network roaming experience.

-  5G NR SA&NSA;3GPP Rel.16
Up to 2.716Gbps DL rate **
-  10000mAh Lithium-ion Battery
-  Reverse Charging
-  2.4 Inch Touch Screen
-  Directly Connect WiFi
-  VPN Client and
VPN passthrough
-  Wi-Fi6 (11ax) AX3600
Wi-Fi auto Optimization
-  ZTE security and
stable FOTA

Abundant management and configuration interfaces

The MU5120 supports local configuration management based on touch screen and mobile apps*, and remote management based on the TR069 and MQTT protocols. This improves user experience and provides cost-effective, efficient, and reliable solutions for operators' requirements for FWA terminal deployment, firmware upgrade, and O&M.

Interface Description

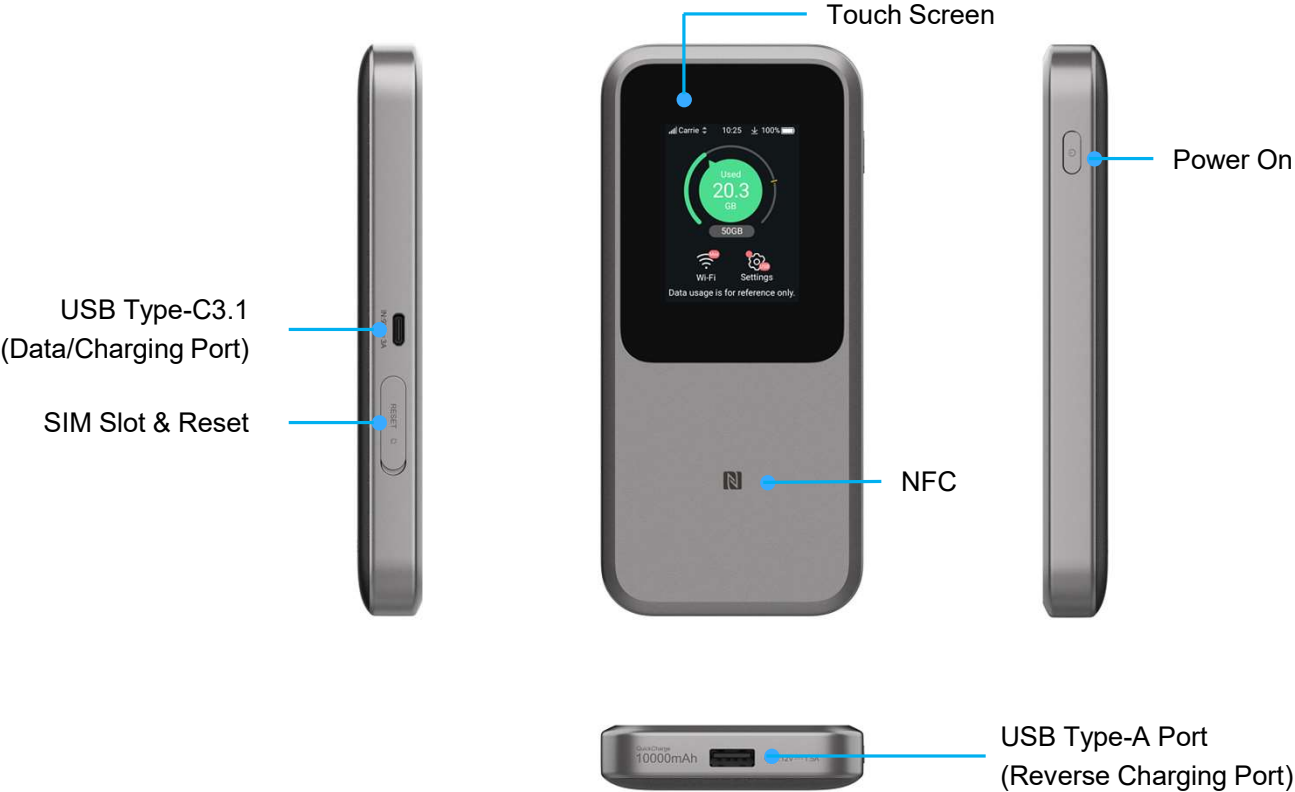

Specifications

Hardware specifications

5G NR Interface

- 3GPP Release 16
- Supports both NSA and SA modes
- Frequencies:
n1/2/3/5/7/8/12/20/28/38/40/41/66/71/75/77/78/79
- 4 MIMO: n1/3/7/38/40/41/66/77/78/79

4G LTE Interface

- 3GPP DL Category19, UL Category18
- Frequencies:
B1/2/3/4/5/7/8/12/17/20/25/26/28/32/66/71/B34/38/39/40/41/42/48
- 4 MIMO: B1/3/4/7/32/38/39/40/41/42/48/66

UMTS Interface

- DC-HSDPA/HSPA+
- Frequencies: B1/2/5/8

Wi-Fi Technology

- Wi-Fi6, 802.11b/g/n/a/ac/ax, 2.4G&5G
- MIMO: 5GHz 2MIMO, 2.4GHz 2MIMO
- Speed: AX3600
- Access number: up to 64

Battery

- Nominal capacity (Catalog value): 9800mAh
- Actual capacity: 8820mAh

Artwork

- Dimensions: 159mm*73mm*18mm
- Weight: about 240g

Certification

- CE, WEEE, ROHS, REACH, Wi-Fi

Software specifications

IP Networking & Routing

- IPv4/IPv6 dual stack (NDP IPv6)
- DHCP server
- VPN client: L2TP/PPTP/IPSec* \GRE*
- VPN pass-through
- NAT/NAPT
- Sip ALG
- Multiple APNs*

Speed**

- 5G ENDC(LTE FDD + Sub6G): DL 2.716Gb/s, UL 280Mb/s
- 5G SA: DL 1.716 Gb/s,UL 160Mb/s
- LTE FDD:DL 1.6Gb/s,UL 200Mbps
- LTE TDD:DL 1.12Gb/s,UL 40Mb/s

Interface

- Touch screen
- USB Type-A: Reverse Charging
- USB Type-C: USB3.1, DATA & Charging
- SIM slot: 4FF/eSIM (default is SIM slot)
- Reset hole to restore factory default
- Power button
- NFC: Andriod phone touch can access Wi-Fi

LCD

- Type: TN
- Size: 2.4 inch
- Resolution: 240*320

Package contents

- AC Adapter (Optional)
Input: 100-240VAC, 50/60Hz, 500mA
Output: DC 5V/3A & 9V/2A & 12V/1.5A
- USB Type-C data cable
- Battery
- Quick Start Guide

Maximum power consumption

- about 15w

Environment

- Operating temperature 0 to 35°C
- Storage temperature -20 to 45°C
- Humidity 5% to 95%

Device Managemnt

- Connected device Management
- SMS
- PIN/PUK management
- APN management
- Lock Frequency/Lock Cell
- TR069 with TR181 data model default
- Upgrade: FOTA/TR069*
- ZTELink APP*

Firewall

- Port Forwarding
- Port Filtering
- Port Mapping
- Domain Filtering
- MAC address Filtering
- Upnp
- DMZ
- Remote Access/Ping switch

Security

- Anti DOS attacks
- Random WebUI & Wi-Fi management Password default
- Wi-Fi access protection

Wi-Fi

- Wi-Fi Switch
- Bandsteering
- Security mode: WPA-PSK/WPA2-PSK, WPA2-PSK/WPA3-PSK,WPA2-PSK
- Wi-Fi Broadcast
- Wi-Fi Isolation
- Auto channel selection
- GuestSSID support
- Wi-Fi Sleep Mode

Special Feature

- Preferred Position: Can help user to find a good position
- Device Diagnosis will list all device running key status and give fix solution

* Optional customized software features.

** The maximum data rates is a theoretical value. The actual data rates depend on the network environment.

*** ZTE Lab test data.

For more product information, visit us on the web at <https://ztedevices.com>

© ZTE. All rights reserved. No spreading without permission of ZTE. All specifications are subject to change without notice.

ZTELink APP

